

OVERVIEW	N134
PNEUMATIC TORQUE WRENCHES	N136
HYDRAULIC TORQUE WRENCHES & PUMPS	N138
AIR DRILLS AND SCREWDRIVERS	N141
INDUSTRIAL HEAVY-DUTY	N146
HYDRAULICS	N150
OIL & GAS INDUSTRY CAPABILITIES	N166



INDUSTRIAL POWER TOOLS

A black and white photograph of a man in a dark, long-sleeved work shirt and safety glasses. He is looking directly at the camera with a slight smile. The background is a blurred industrial setting. The text is overlaid on the bottom left of the image.

POWER TOOLS THAT DESERVE PROPS.

No matter how big or small the job, Snap-on provides the industrial power tools to cover the entire range of needs. Every tool is designed under the strict supervision of Snap-on engineers and product specialists, and built to surpass even the most rigorous professional demands. Plus, Snap-on tools always deliver the comfort, reliability and durability you want, and the power and speed you need. No matter what size your job is, Snap-on offers the industrial power tools that get it done right.

Power that's anything but conventional.

RELIABILITY

With Snap-on, you always get the most reliable industrial power tools in the marketplace. By using the best materials, we deliver both durability and performance (speed and accuracy).

SAFETY

Our industrial power tools feature precision-machined gears, which reduce the usual vibration found in competitive tools with lower quality components. And to further ensure operator safety, Snap-on offers a wide range of additional safety-related product features.

VERSATILITY

The Snap-on Pneumatic and Hydraulic Torque Wrenches are ideal for oil fields, construction, shipyards, power generation, railroads, mining equipment maintenance and more. A variety of high-strength reaction arms are available to fit nearly any application.

PNEUMATIC TORQUE



PTM1000

Pneumatic Torque Wrenches

PTM Features:

- Twin motor technology allows the PTM to be both light weight and fast
- Compact and powerful, allowing excellent access to a variety of threaded fasteners
- The secondary trigger ensures hands are away from pinch points during operation
- Run-down speeds up to 122 RPM (for PTM740)
- A wide variety of reaction fixtures are available, making this an extremely versatile tool
- These are non-impacting tools with low vibration levels
- Operate at noise levels below 85 dB (under load)
- Gearbox rotates independently from the handle so reaction forces are never transferred back to the operator
- All tools are supplied with a certificate of calibration and torque vs. pressure chart
- PTM series offers a wide range of torque output, from 74–4,500 ft-lb
- Accuracy of $\pm 5\%$
- Includes case, cranked reaction fixture, tool hanger, secondary handle and male quick connect

Stock No.	Torque Range (ft-lb)	Torque Range (N•m)	Square Drive Size
PTM370	74–370	100–500	3/4
PTM590	118–590	160–800	3/4
PTM740	147–740	200–1,000	3/4
PTM1000	200–1,000	270–1,350	1
PTM1475	295–1,475	400–2,000	1
PTM1990	400–1,990	540–2700	1
PTM2950	590–2,950	800–4,000	1-1/2
PTM3300	660–3,320	900–4,500	1-1/2
PTM4400	885–4,425	1200–6,000	1-1/2

Pneumatic Torque Filter/Regulators

PTMFRL Filter/Regulator Unit (required to operate tool)

- Filter and lubricator in one unit
- Large pressure gauge allows operator to easily select the appropriate pressure
- Adjustable lubricator provides the proper amount of lubrication for PTM series of tools



PTMFRL

The Right Angle Gearbox enables the benefits of our pneumatic torque tools to be brought to a host of applications from which they are currently excluded due to space limitations. The Right Angle Gearbox can be purchased as a stand-alone product and retrofitted to existing tools by qualified technicians. It is recommended the tool be recalibrated after a Right Angle Gearbox has been fitted.



PTM shown with Right Angle Gearbox



MTMC18293
Double sided reaction fixture



SRF18241
Short Reaction Foot



SR18291
Straight Reaction



SRP18298
Straight Reaction with Peg

Reaction Fixture Accessories

PTM	Reaction Arm	Description	Length (inches)	Offset (inches)
PTM370 PTM590	MTMC18646	Steel Cranked	5.2	3.2
	MTMC218590	Double Sided	9.8 (OAL)	-
	MTMC218576	Straight Plate	9.8	-
	MTMC218694	Weld Ring	-	-
	RA18558	Reaction Adaptor	-	-
	SR52B06	Sliding Reaction	9.8	-
PTM740 PTM1000 PTM1475	MTMC19289	Steel Cranked	5.6	3.9
	ACR18494	Al Cranked	6.6	3.9
	MTMC18293	Double Sided	7.9 (OAL)	-
	MTMC18292	Straight Plate	6.9	-
	MTMC18695	Weld Ring	-	-
	RA18290	Reaction Adaptor	-	-
	SR72B06	Sliding Reaction (3/4" SD)	11.8	-
SR72B08	Sliding Reaction (1" SD)	11.8	-	
PTM370 PTM590 PTM740 PTM1000 PTM1475	SRF18241	Short Reaction Foot	2.55	3
	SR18291	Straight Reaction	11.8	-
	SRP18298	Straight Reaction with Peg	11.8	4.5
PTM1990 PTM2950	MTMC19291	Steel Cranked	6.9	4.1
	ACR18936	Al Cranked	8.1	4.9
	MTMC18980	Double Sided	9.5 (AOL)	-
	MTMC18979	Straight Plate	7.9	-
	MTMC18696	Weld Ring	-	-
	SR92B08	Sliding Reaction (1" SD)	11.8	-
SR92B12	Sliding Reaction (1 1/2" SD)	11.8	-	
PTM3300 PTM4400	MTMC19293	Steel Cranked	8.3	3.9
	ACR18961	Al Cranked	7.8	6.2
	MTMC18981	Double Sided	11.8 (OAL)	-
	MTMC16687	Straight Plate	13.8	-
	MTMC18697	Weld Ring	-	-
SR119B12	Sliding Reaction	11.8	-	



- Must wear eye protection
- Read safety precautions on pages W1 to W2

HYDRAULIC TORQUE WRENCHES

Snap-on Hydraulic Torque Wrenches

Snap-on hydraulic torque wrenches are some of the most field proven tools in the world market today. They are recommended for all torque applications.

Our one-way ratchet assures...

- Each nut is turned 24 degrees to avoid a slow down due to bolt torsion as fasteners are getting tight.
- Heavily corroded nuts usually create torsion in the bolt. It can be overcome with a second stroke at full torque as the ratchet is a one-way ratchet that does not inadvertently let bolt torsion relax.
- On vertical applications, our tools find their proper reaction point without being held against it.
- Ideal to use four tools to close flanges parallel.

- Compact, ergonomic design for torque requirements up to 37,000 ft-lbs
- High strength metal square drive for performance and durability
- 360 degree rotatable tension absorbing reaction arm for a perfect fit on many jobs
- Uniswivel technology for free movement and positioning of tool and hoses
- Snap-on HTQ wrenches provide plus or minus 3% accuracy

Hydraulic Square Drive Torque Wrenches

Stock No.	Square Drive Size	Torque Range Ft. Lb. (Nm)
HTQ.7	3/4"	120-822 (167-1,114)
HTQ1	1"	190-1,340 (272-1,817)
HTQ3	1"	450-3,230 (657-4,379)
HTQ5	1 1/2"	720-5,590 (1,137-7,578)
HTQ8	1 1/2"	1,200-8,000 (1627-10,845)
HTQ10	1 1/2"	2,200-11,520 (2,343-15,617)
HTQ20	2 1/2"	3,050-19,750 (4,018-26,787)
HTQ25	2 1/2"	3,960-25,890 (5368-35,096)
HTQ35	2 1/2"	5,400-37,100 (7,544-50,293)

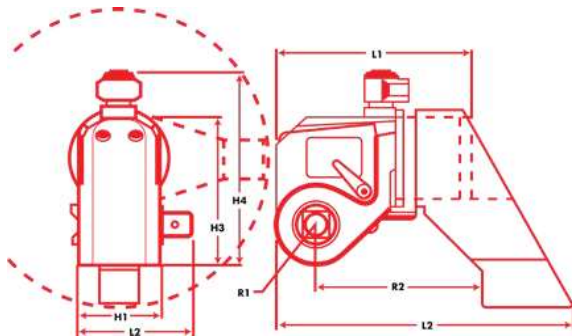

HTQ3

Technical Specifications

Stock No.	L1 Inches (mm)	L2 Inches (mm)	L3 Inches (mm)	H1 Inches (mm)	H2 Inches (mm)	H3 Inches (mm)	H4 Inches (mm)	R1 Inches (mm)	R2 Inches (mm)	Weight lbs (kg)
HTQ.7	3.96 (100.6)	5.98 (151.9)	.93 (23.6)	1.62 (41.2)	2.53 (64.3)	3 (76.2)	4.25 (108)	.81 (20.6)	3.32 (84.3)	2.7 (1.2)
HTQ1	4.88 (123.9)	7.33 (186.2)	1.13 (28.7)	1.97 (50)	2.85 (72.4)	3.66 (93)	4.9 (124.5)	.98 (25)	4.12 (104.7)	3.95 (1.8)
HTQ3	6.34 (161)	9.6 (243.8)	1.51 (38.4)	2.63 (66.8)	3.81 (96.8)	4.88 (124)	6.12 (155.5)	1.31 (33.3)	5.32 (135.1)	8.3 (3.8)
HTQ5	7.61 (193.3)	11.52 (292.6)	1.81 (46)	3.16 (80.3)	4.92 (125)	5.85 (148.6)	7.22 (183.4)	1.57 (39.9)	6.4 (162.6)	14.2 (6.5)
HTQ8	8.43 (214.2)	12.47 (316.73)	1.70 (43.18)	3.57 (90.7)	5.23 (132.8)	6.38 (162)	8.07 (205.2)	1.70 (43.2)	6.97 (177.6)	32.5 (14.75)
HTQ10	9.51 (241.6)	14.38 (365.3)	2.26 (57.4)	3.95 (100.3)	5.62 (142.8)	7.32 (185.9)	8.8 (223.5)	1.96 (48.8)	7.97 (202.4)	24.8 (11.3)
HTQ20	11.41 (298.8)	17.27 (438.7)	2.71 (68.8)	4.73 (120.1)	7.1 (180.3)	8.78 (223)	10.24 (260.1)	2.36 (59.9)	9.58 (243.3)	43.4 (19.7)
HTQ25	6.81 (173.05)	18.52 (470.33)	2.59 (65.87)	5.25 (133.35)	7.57 (192.28)	9.87 (250.69)	11.44 (290.57)	2.50 (65.87)	10.25 (260.35)	75.6 (34.3)
HTQ35	14.03 (356.3)	21.23 (539.2)	3.33 (84.6)	5.82 (147.8)	8.32 (211.3)	10.79 (274.1)	12.36 (313.9)	2.9 (73.7)	11.74 (298.2)	77.45 (35.2)

HYDRAULIC TORQUE WRENCHES

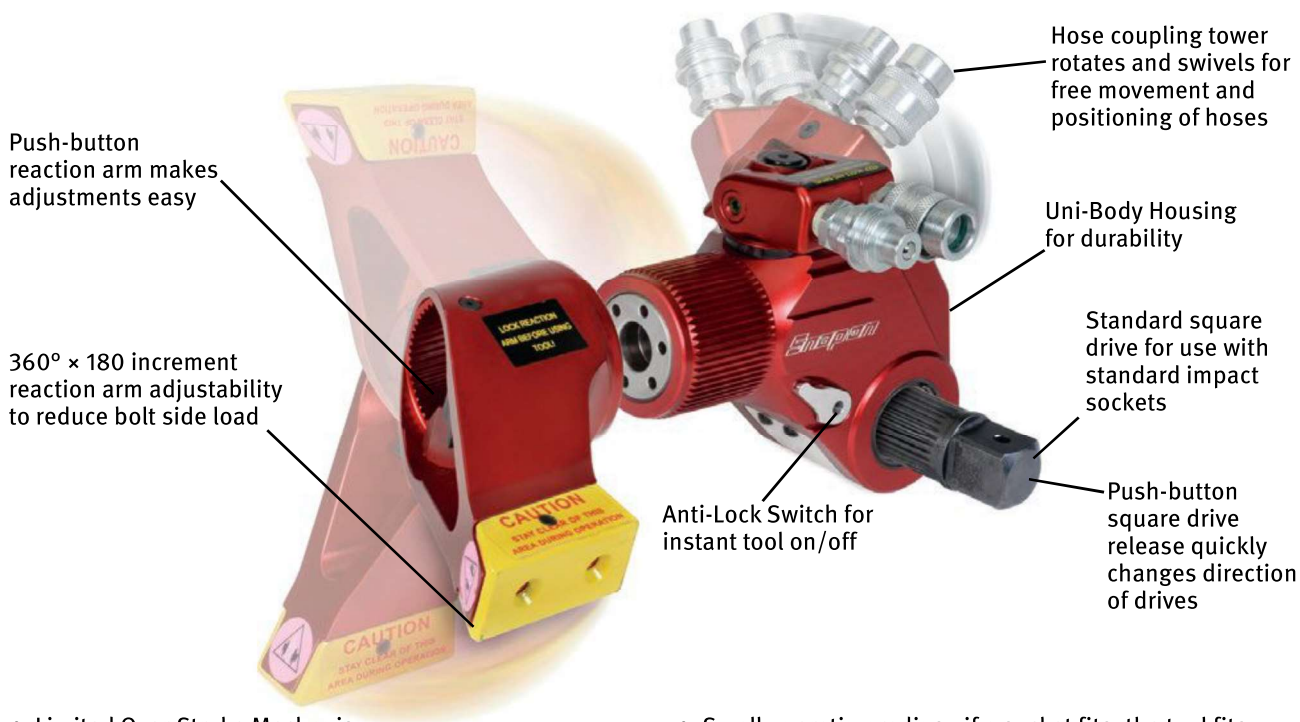

- Limited Over-Stroke Mechanism
- Dual Pawl Mechanism provides problem free operation and equal load ratchet mechanism
- Corrosion free finish
- Piston design prevents side load and the cylinder is maintenance free

- Small operating radius...if a socket fits, the tool fits
- Ergonomic design
- An anti-backlash mechanism is the only way to get full torque on a corroded nut and prevent pre-stall or turning speed slow down. It is a must to operate multiple torque tools with a single hand and your only assurance to get preset torque on all fasteners no matter what!

HYDRAULIC PUMPS



Hydraulic Pumps for Snap-on Hydraulic Torque Wrenches

Stock No.	HTQPP	HTQEP
Description	Air driven power pack	Electric driven power pack (115/230v)
Tank	1 gallon	1 gallon
STAGES	3	3
FLOW RATE	770 cu. In. min	620 cu. In. min
Voltage	N/A	115/230
Average (115V)	N/A	15 amp
Average (230V)	N/A	7 amp
Air Volume	3800 cu. In/sec	N/A
Gauge	0-10K PSI (+/-1% ACC)	0-10K PSI (+/-1% ACC)



- Must wear eye protection
- Read safety precautions on pages W1 to W2

LOW PROFILE HYDRAULIC TORQUE

LTQ™ Series Torque Wrench System



LTQ4 Torque Wrench Assembled



Cassette



Retaining Pin



Removable Handle



Wrench

(5 models available)

LTQ™ Series

Limited Clearance Torque Wrench System

- Low profile makes this wrench especially well-suited for limited clearance applications
- Rugged design suitable for heavy industry applications
- Five models with torque output up to 30,982 ft-lbs
- Wide array of wrench/cassette combinations available, covering all fractional hex sizes from 1-1/4" to 6-1/8"
- Complete selection of fractional hex sizes available
- Cassettes are quickly and easily changed
- Uniswivel technology for free movement and positioning of tool and hoses
- Square drive conversion available for use with sockets
- Plus or minus 3% accuracy
- Custom reaction arms are available

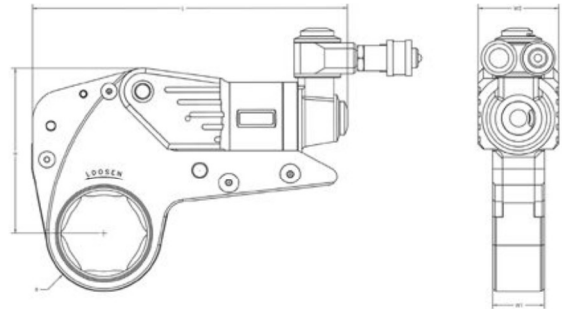

Stock No.	Cassette Size Range	L	H	W1	W2	R	Weight (without cassette)	Minimum Torque	Maximum Torque
LTQ2	1-1/4" - 2-3/16"	7.33	4.02	1.26	1.94	1.03 to 1.98	2.05	243	1687
LTQ4	1-13/16" - 2-3/4"	10.06	5.36	1.68	2.58	1.32 to 2.67	4.25	580	3,855
LTQ8	2-3/16" - 3-7/8"	12.08	6.69	2.08	2.23	1.78 to 2.91	7.15	1,142	8,149
LTQ14	2-3/4" - 4-5/8"	14.14	8.04	2.50	3.63	2.62 to 3.48	11.30	2,010	13,398
LTQ30	3-1/2" - 6-1/8"	16.80	10.71	3.33	5.17	3.02 to 4.71	23.80	4,578	30,982



LTQ™ Series Interchangeable Cassettes

- For a complete selection of cassette hex sizes available (1-1/4" to 6-1/8") scan this QR code or contact your Snap-on Industrial Representative today



AVIATION AIR DRILLS

Snap-on Industrial drills are used in aviation applications ranging from light assembly to metalworking. Their powerful five vane motors makes these drills great for drilling applications that contain ferrous and non-ferrous metals, plastics, and composite materials.

Built for durability, their 3 planet gear system delivers superior life and load capacity. The Snap-on Industrial

Drop in motor with no alignment required on non-reversing models
Alignment pin on reversing models is on front end plate

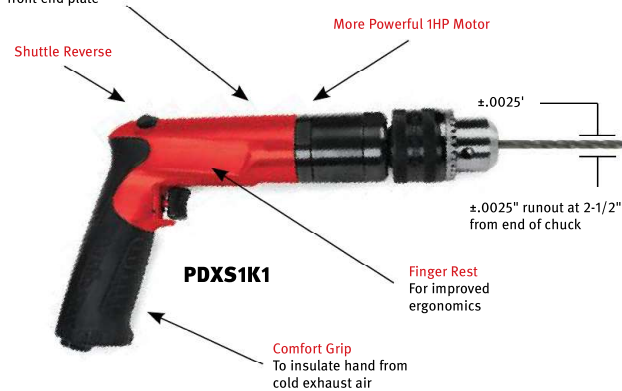

drills offer maximum comfort with reduced operator fatigue by offering a low sound level and low vibration solution. Operator comfort is achieved through the implementation of a light weight aluminum housing and a comfort grip. Drills are available in both reversing and non-reversing pistol grip and lever handle configurations.

Performance

Powerful 1.0 HP motors easily handle a wide range of drilling applications

- With excellent run-out characteristics, (+/- 0.0025" @ 2.5" from the end of the chuck) drills provide precision required for critical applications
- Teasing trigger provides excellent speed control

Ergonomics

- Comfortable, compact drill bodies includes finger rests on the side of tool do not protrude which allows trigger actuation with stronger middle finger
- Anatomic design keeps wrist and arm straight, allows high feed forces
- Low noise and vibration levels for comfort in extended use operations

Serviceability

- Drop in motors with no alignment required (applies to non-reversing drills only)
- High part interchangeability = lower service part inventories

Reversible Pistol Grip Air Drills

Style	Stock No. (Keyed Chuck)	Stock No. (Keyless Chuck)	Chuck Capacity in (mm)	Free Speed RPM	Weight lb (kg)	Length in (mm)	Spindle Thread
1.0 hp (0.75 kw) Reversible	PDXF1K1	PDXF1L1	3/8 (10)	550	3.1 (1.4)	8.6 (220)	3/8"-24
	PDXF1K5	PDXF1L5	3/8 (10)	1500	2.6 (1.15)	7.6 (195)	3/8"-24
	PDXF1K6	PDXF1L6	3/8 (10)	2050	2.6 (1.15)	7.6 (195)	3/8"-24
	PDXS1K1	PDXS1L1	1/2 (13)	550	3.6 (1.6)	9.1 (230)	1/2"-20

1/4" Micro Reversible Air Drill

- 0.25 HP at 1,800 max RPM
- One handed forward/reverse for easy operation
- Variable speed trigger for precise tool control
- Comfort cushion grip allows you to work all day
- Excellent runout for consistent drilling, reaming and honing
- Industrial drivetrain and gearing for long tool life
- Keyless chuck model for rapid bit change
- Slow start up for easy control
- Handle exhaust directs air downward
- All ball and needle bearing spindle components
- Machined planetary gears balance the load



Style	Stock No. (Keyed Chuck)	Stock No. (Keyless Chuck)	Chuck Capacity in (mm)	Free Speed RPM	Weight lb (kg)	Length in (mm)
0.25 hp Micro Reversible	PDR2500	PDR2501	1/4 (6)	1800	1.5 (.68)	6.1 (155)

Non-Reversible Pistol Grip Air Drills

Style	Stock No. (Keyed Chuck)	Stock No. (Keyless Chuck)	Chuck Capacity in (mm)	Free Speed RPM	Weight lb (kg)	Length in (mm)	Spindle Thread
1.0 hp (0.75 kw) Reversible	PDXT2K7	-	1/4 (6)	2600	2.3 (1.05)	6.5 (165)	3/8"-24
	PDXT2K8	-	1/4 (6)	3500	2.3 (1.05)	6.5 (165)	3/8"-24
	PDXT2K9	-	1/4 (6)	5500	2.3 (1.05)	6.5 (165)	3/8"-24
	PDXF2K0	-	3/8 (10)	450	2.9 (1.3)	8 (205)	3/8"-24
	PDXF2K2	-	3/8 (10)	600	2.9 (1.3)	8 (205)	3/8"-24
	PDXF2K3	PDXF2L3	3/8 (10)	900	2.9 (1.3)	8 (205)	3/8"-24
	PDXF2K4	PDXF2L4	3/8 (10)	1350	2.9 (1.3)	8 (205)	3/8"-24
	PDXF2K7	PDXF2L7	3/8 (10)	2600	2.5 (1.1)	7 (180)	3/8"-24
	PDXF2K8	PDXF2L8	3/8 (10)	3500	2.5 (1.1)	7 (180)	3/8"-24
	PDXF2K9	PDXF2L9	3/8 (10)	5500	2.5 (1.1)	7 (180)	3/8"-24
	PDXS2K0	PDXS2L0	1/2 (13)	450	3.3 (1.5)	8.5 (215)	1/2"-20
	PDXS2K2	PDXS2L2	1/2 (13)	600	3.3 (1.5)	8.5 (215)	1/2"-20
	PDXS2K3	PDXS2L3	1/2 (13)	900	3.3 (1.5)	8.5 (215)	1/2"-20
	PDXS2K4	PDXS2L4	1/2 (13)	1350	3.3 (1.5)	8.5 (215)	1/2"-20
	PDXS2K7	PDXS2L7	1/2 (13)	2600	2.9 (1.3)	7.5 (190)	1/2"-20



- Must wear eye protection
- Read safety precautions on pages W1 to W2

INDUSTRIAL POWER TOOLS

PRODUCTION AIR DRILLS



Sioux drills are used in applications ranging from light assembly to metalworking, manufactured housing and wood working. Their powerful five vane motors makes these drills great for drilling applications that contain ferrous and non-ferrous metals, wood and composite materials.

Built for durability, their 3 planet gear system delivers superior life and load capacity. The Sioux drills offer

maximum comfort with reduced operator fatigue by offering a low sound level and low vibration solution. Operator comfort is achieved through the implementation of a light weight aluminum housing and a comfort grip. Drills are available in both reversing and non-reversing pistol grip and lever handle configurations.



Performance

- Powerful 0.6 HP and 1.0 HP motors easily handle a wide range of drilling applications
- With excellent run-out characteristics, (+/- 0.0025" @ 2.5" from the end of the chuck) Sioux drills provide precision required for critical applications
- Teasing trigger provides excellent speed control

Ergonomics

- Comfortable, compact drill bodies includes finger rests on the side of tool do not protrude which allows trigger actuation with stronger middle finger
- Anatomic design keeps wrist and arm straight, allows high feed forces
- Low noise and vibration levels for comfort in extended use operations

Serviceability

- Drop in motors with no alignment required (applies to non-reversing drills only)
- High part interchangeability = lower service part inventories

Reversible Air Drills

- Pistol Grip (0.6 HP & 1.0 HP) - Shuttle Reverse
- Right Angle Drills (1.0 HP) - Rapid Reverse
- Side to Center = 0.8" (20mm)
- Max Air Consumption:
 - 0.6 HP Drills - 25 scfm (12 l/s)
 - 1.0 HP Drills - 30 scfm (14 l/s)



Style	Stock No.	Chuck Capacity in (mm)	Free Speed RPM	Weight lbs (kg)	Length in (mm)	Spindle Thread	Sound Level dB(A)
1.0 hp (0.75 kw) Pistol Grip Drills - Reversible	SDR10P40R2	¼(6)	4,000	2.4 (1.1)	7.1 (180)	¾" - 24	80
	SDR10P25R2	¼(6)	2,500	2.4 (1.1)	7.1 (180)	¾" - 24	
	SDR10P20R2	¼(6)	2,000	2.4 (1.1)	7.1 (180)	¾" - 24	
	SDR10P40R3	⅜(10)	4,000	2.6 (1.2)	7.6 (195)	¾" - 24	
	SDR10P25R3	⅜(10)	2,500	2.6 (1.2)	7.6 (195)	¾" - 24	
	SDR10P20R3	⅜(10)	2,000	2.6 (1.2)	7.6 (195)	¾" - 24	
	SDR10P7R3	⅜(10)	700	3.1 (1.4)	8.6 (220)	½" - 20	
	SDR10P5R3	⅜(10)	500	3.1 (1.4)	8.6 (220)	½" - 20	
	SDR10P3R3	⅜(10)	300	3.1 (1.4)	8.6 (220)	½" - 20	
	SDR10P20R4	½(13)	2,000	3.0 (1.4)	7.9 (200)	½" - 20	
	SDR10P7R4	½(13)	700	3.6 (1.6)	9.1 (230)	½" - 20	
	SDR10P5R4	½(13)	500	3.6 (1.6)	9.1 (230)	½" - 20	
	SDR10P3R4	½(13)	300	3.6 (1.6)	9.1 (230)	½" - 20	
1.0 hp (0.75 kw) RIGHT Angle Drills - Reversible	SDR10A20R2	¼(6)	2,000	2.9 (1.3)	11 (280)	¾" - 24	78
	SDR10A16R2	¼(6)	1,600	3.2 (1.4)	12 (305)	¾" - 24	
	SDR10A20R3	⅜(10)	2,000	3 (1.35)	11 (280)	½" - 20	
	SDR10A16R3	⅜(10)	1,600	3.3 (1.5)	12 (305)	½" - 20	
	SDR10A10R3	⅜(10)	1,000	3.3 (1.5)	12 (305)	½" - 20	
	SDR10A6R3	⅜(10)	600	3.3 (1.5)	12 (305)	½" - 20	
	SDR10A3R3	⅜(10)	300	3.3 (1.5)	12 (305)	½" - 20	
	SDR10A10R4	½(13)	1,000	3.7 (1.7)	12 (305)	½" - 20	
	SDR10A6R4	½(13)	600	3.7 (1.7)	12 (305)	½" - 20	
SDR10A3R4	½(13)	300	3.7 (1.7)	12 (305)	½" - 20		





PRODUCTION AIR DRILLS

INDUSTRIAL POWER TOOLS

- Tipper valve and valve seat is easily accessible for service
- Slip fit of front end plate bearing allows easy service of the air motor without disturbing the rotor spacing
- Drop in motor. No alignment necessary (applies to non-reversing drills only)
- Rotor pinion is case hardened to resist wear
- Grease zerk makes it easy to grease the gears without disassembly
- Planetary reduction can be serviced without removing the chuck
- Planet gear pins are slip fit for ease of assembly and disassembly
- Ring gear is machined into the motor retainer for ease of assembly and disassembly
- Interchangeable rotor, cylinder, bearings and endplates. This reduces the number of spare parts tool cribs need to stock



CE

Non-Reversible Air Drills

- Pistol Grip (0.6 HP & 1.0 HP)
 - Straight Drills (1.0 HP)
 - Right Angle Drills (1.0 HP)
 - Side to Center = 0.8" (20mm)
- Max Air Consumption:
- 0.6 HP Drills - 25 scfm (12 l/s)
 - 1.0 HP Drills - 30 scfm (14 l/s)



SDR10P26N3



SDR10S26N3



SDR10A22N3

Style	Stock No.	Chuck Capacity in (mm)	Free Speed RPM	Weight lbs (kg)	Length in (mm)	Spindle Thread	Sound Level dB(A)
.60 hp (0.45 kw) PISTOL GRIP DRILLS-Non-Reversible	SDR6P60N2	¼(6)	6,000	2.1 (0.95)	5.8 (145)	¾"-24	80
	SDR6P40N2	¼(6)	4,000	2.1 (0.95)	5.8 (145)	¾"-24	
	SDR6P26N2	¼(6)	2,600	2.1 (0.95)	5.8 (145)	¾"-24	
	SDR6P60N3	⅜(10)	6,000	2.3 (1)	6.3 (160)	¾"-24	
	SDR6P40N3	⅜(10)	4,000	2.3 (1)	6.3 (160)	¾"-24	
	SDR6P26N3	⅜(10)	2,600	2.3 (1)	6.3 (160)	¾"-24	
	SDR6P12N3	⅜(10)	1,200	2.7 (1.2)	7.3 (185)	½"-20	
	SDR6P7N3	⅜(10)	700	2.7 (1.2)	7.3 (185)	½"-20	
	SDR6P4N3	⅜(10)	400	2.7 (1.2)	7.3 (185)	½"-20	
	SDR6P26N4	½(13)	2,600	2.7 (1.2)	6.6 (170)	½"-20	
	SDR6P7N4	½(13)	700	3.1 (1.4)	7.8 (200)	½"-20	
	SDR6P4N4	½(13)	400	3.1 (1.4)	7.8 (200)	½"-20	
1.0 hp (0.75 kw) PISTOL GRIP DRILLS-Non-Reversible	SDR10P280N2	¼(6)	21,000	2.3 (1.05)	6.5 (165)	¾"-24	80
	SDR10P180N2	¼(6)	18,000	2.3 (1.05)	6.5 (165)	¾"-24	
	SDR10P60N2	¼(6)	6,000	2.3 (1.05)	6.5 (165)	¾"-24	
	SDR10P40N2	¼(6)	4,000	2.3 (1.05)	6.5 (165)	¾"-24	
	SDR10P26N2	¼(6)	2,600	2.3 (1.05)	6.5 (165)	¾"-24	
	SDR10P60N3	⅜(10)	6,000	2.5 (1.1)	7 (180)	¾"-24	
	SDR10P40N3	⅜(10)	4,000	2.5 (1.1)	7 (180)	¾"-24	
	SDR10P26N3	⅜(10)	2,600	2.5 (1.1)	7 (180)	¾"-24	
	SDR10P12N3	⅜(10)	1,200	2.9 (1.3)	8 (205)	½"-20	
	SDR10P7N3	⅜(10)	700	2.9 (1.3)	8 (205)	½"-20	
	SDR10P4N3	⅜(10)	400	2.9 (1.3)	8 (205)	½"-20	
	SDR10P26N4	½(13)	2,600	2.9 (1.3)	7.5 (190)	½"-20	
SDR10P7N4	½(13)	700	3.3 (1.5)	8.5 (215)	½"-20		
SDR10P4N4	½(13)	400	3.3 (1.5)	8.5 (215)	½"-20		
1.0 hp (0.75 kw) STRAIGHT DRILLS-Non-reversible	SDR10S280N2	¼(6)	21,000	2.3 (1.05)	8.3 (211)	¾"-24	78
	SDR10S180N2	¼(6)	18,000	2.3 (1.05)	8.3 (211)	¾"-24	
	SDR10S60N2	¼(6)	6,000	2.3 (1.05)	8.3 (211)	¾"-24	
	SDR10S40N2	¼(6)	4,000	2.3 (1.05)	8.3 (211)	¾"-24	
	SDR10S26N2	¼(6)	2,600	2.3 (1.05)	8.3 (211)	¾"-24	
	SDR10S60N3	⅜(10)	6,000	2.3 (1.05)	8.3 (211)	¾"-24	
	SDR10S40N3	⅜(10)	4,000	2.3 (1.05)	8.3 (211)	¾"-24	
	SDR10S26N3	⅜(10)	2,600	2.3 (1.05)	8.3 (211)	¾"-24	
	SDR10S12N3	⅜(10)	1,200	2.8 (1.25)	9.3 (236)	½"-20	
	SDR10S7N3	⅜(10)	700	2.8 (1.25)	9.3 (236)	½"-20	
	SDR10S4N3	⅜(10)	400	2.8 (1.25)	9.3 (236)	½"-20	
	SDR10S4N4	½(13)	400	2.8 (1.25)	9.3 (236)	½"-20	
1.0 hp (0.75 kw) RIGHT ANGLE DRILLS - Non-Reversible	SDR10A22N2	¼(6)	2,200	2.9 (1.3)	10.2 (260)	¾"-24	78
	SDR10A13N2	¼(6)	1,300	3.2 (1.4)	11.2 (285)	¾"-24	
	SDR10A22N3	⅜(10)	2,200	3.0 (1.35)	10.2 (260)	½"-20	
	SDR10A13N3	⅜(10)	1,300	3.3 (1.5)	11.2 (285)	½"-20	
	SDR10A10N3	⅜(10)	1,000	3.3 (1.5)	11.2 (285)	½"-20	
	SDR10A4N3	⅜(10)	400	3.3 (1.5)	11.2 (285)	½"-20	
	SDR10A10N4	½(13)	1,000	3.7 (1.65)	11.2 (285)	½"-20	
	SDR10A4N4	½(13)	400	3.7 (1.65)	11.2 (285)	½"-20	



- Must wear eye protection
- Read safety precautions on pages W1 to W2

RUNNERS AND T-HANDLE DRILLS



2S2300SR



SSR6P25

Skin Clamp Runners

- Speed: 2200 rpm - 2500 rpm
- Pistol Grip and Z-Handle
- 1/2-12 Point Internal, 9/16-6 Point External Hex

CE

Style	Model Number	Free Speed rpm	Weight lb (kg)	Length in (mm)	Side to Center in (mm)	Air Consumption Free Speed cfm (l/s)	Sound Level dB(A)
Z-Handle	2S2300SR	2200	2.6 (1.2)	5.7 (145)	0.9 (23)	16 (8)	75
Pistol Grip	SSR6P25	2500	2.7 (1.2)	9.2 (234)	0.9 (23)	30 (14)	78

General: Air Inlet Size: 1/4" NPT • Recommended Hose Size: 3/8" (10 mm) • Performance rated @ 90 psig (6.2 bar) air pressure
 Standard Equipment: Parts List • Safety and Instruction Manual • Comfort Grip (Pistol Grip models)
 Accessories: Skin Clamp Runner Accessories



SDR10T4N4



3T1630

T-Handle Drills

- Power: 1 hp (0.75 kW), Speed Range: 360 rpm – 4000 rpm, Chuck Capacity: 3/8" (10 mm) – 1/2" (13 mm)
- Non-Reversible
- Lever Start
- Handle Grips

Style	Model Number	Chuck Capacity in (mm)	Free Speed rpm	Weight lb (kg)	Length in (mm)	Side To Center in (mm)	Maximum Air Consumption cfm (ls)	Sound Level dB(A)	Spindle Thread
Signature Series 1 hp (0.75 kW) Non-reversible	SDR10T4N4	1/2 (13)	400	6.3 (2.9)	36 (914)	0.85 (21.6)	35 (17)	80	1/2"-20
	SDR10T7N4	1/2 (13)	700	6.3 (2.9)	36 (914)	0.85 (21.6)	35 (17)	80	1/2"-20
	SDR10T12N4	1/2 (13)	1200	6.3 (2.9)	36 (914)	0.85 (21.6)	35 (17)	80	1/2"-20
	SDR10T16N4	1/2 (13)	1600	6.3 (2.9)	36 (914)	0.85 (21.6)	35 (17)	80	1/2"-20
	SDR10T26N3	3/8 (10)	2600	5.6 (2.5)	36 (914)	0.85 (21.6)	35 (17)	80	3/8"-24
	SDR10T26N4	1/2 (13)	2600	5.9 (2.7)	36 (914)	0.85 (21.6)	35 (17)	80	1/2"-20
	SDR10T40N3	3/8 (10)	4000	5.6 (2.5)	36 (914)	0.85 (21.6)	35 (17)	80	3/8"-20
3 - Series 1 hp (0.75 kW) Non-reversible	3T1140	1/2 (13)	360	7.6 (3.5)	35 (889)	1 (25)	35 (17)	80	1/2"-20
	3T1340	1/2 (13)	1000	7.6 (3.5)	35 (889)	1 (25)	35 (17)	80	1/2"-20
	3T1530	3/8 (10)	2150	7.3 (3.3)	35 (889)	1 (25)	35 (17)	80	1/2"-20
	3T1630	3/8 (10)	2650	7.3 (3.3)	35 (889)	1 (25)	35 (17)	80	1/2"-20
	3T1640	1/2 (13)	2650	7.4 (3.4)	35 (889)	1 (25)	35 (17)	80	1/2"-20

General: Air Inlet Size: 1/4" NPT • Recommended Hose Size: 3/8" (10 mm) • Performance rated @ 90 psig (6.2 bar) air pressure
 Standard Equipment: Parts List • Safety and Instruction Manual • 3-jaw Chuck and Key • Comfort Grip
 Accessories: Drill Accessories

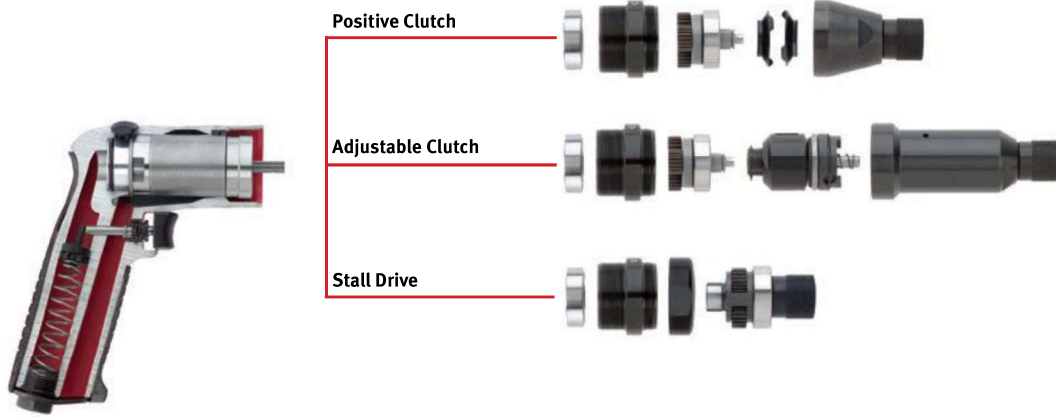

Positive Clutch, Adjustable Clutch and Stall Driver Screwdrivers

- Trigger start with conveniently located shuttle reverse
- 3 planet gear system for increased life and load capacity
- Comfortable, compact tool bodies include finger rests on side of tool, allowing trigger actuation with stronger middle finger
- Teasing throttle for excellent control
- Side to Center - 0.8" (20mm)
- Maximum air Consumption – 30 scfm (13 l/s)
- Contact your Snap-on Industrial salesman to request a complete listing of Sioux Screwdrivers and Nutrunners



SSD10P20AC



SSD10P20PS

CE



SSD10P20S

Clutch Type	Stock No.	Max. Torque (Soft Joint) in. (mm)	Free Speed RPM	Weight lbs (kg)	Length in (mm)	Sound Level dB(A)
1.0 hp (0.75 kw) Positive Clutch Pistol Grip Screwdrivers - torque output varies with force exerted by operator	SSD10P25PS	58 (6.5)	2500	2.4 (1.07)	7.3 (185)	80
	SSD10P20PS	80 (9.0)	2000	2.4 (1.07)	7.3 (185)	
	SSD10P12PS	145 (16.4)	1200	2.8 (1.30)	9.1 (231)	
1.0 hp (0.75 kw) Adjustable Clutch Pistol Grip Screwdrivers - when fastener is tight, clutch will ratchet. Adjusting spring pressure will effect final output torque. Offers consistent torque control with little operator reaction	SSD10P25AC	60 (6.8)	2500	2.8 (1.25)	8.4 (213)	80
	SSD10P20AC	80 (9.0)	2000	2.8 (1.25)	8.4 (213)	
	SSD10P12AC	120 (13.5)	1200	3.2 (1.45)	10.2 (259)	
	SSD10P7AC	140 (15.8)	700	3.2 (1.45)	10.2 (259)	
	SSD10P5AC	140 (15.8)	500	3.2 (1.45)	10.2 (259)	
	SSD10P3AC	140 (15.8)	300	3.2 (1.45)	10.2 (259)	
1.0 hp (0.75 kw) Stall Drive Pistol Grip Screwdrivers - final torque is reached when resistance of the fastener overcomes the torque output of the motor. Final torque can be influenced by air pressure and/or operator twisting the tool	SSD10P25S	58 (6.6)	2500	2.2 (0.98)	6.5 (165)	80
	SSD10P20S	80 (9.0)	2000	2.2 (0.98)	6.5 (165)	
	SSD10P12S	145 (16.4)	1200	2.6 (1.17)	7.5 (191)	
	SSD10P7S	220 (24.9)	700	2.6 (1.17)	7.5 (191)	
	SSD10P5S	325 (36.7)	500	2.6 (1.17)	7.5 (191)	
	SSD10P3S	400 (45.2)	300	2.6 (1.17)	7.5 (191)	



SDR10P25R3



- Must wear eye protection
- Read safety precautions on pages W1 to W2

AIR DIE GRINDERS

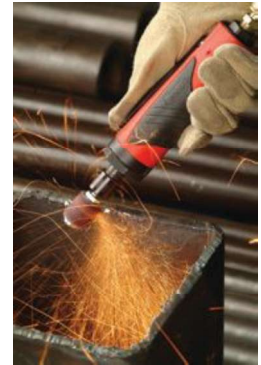

Signature Series Die Grinders

- Unmatched performance and real productivity
- Ideal for grinding, cutting, weld dressing, blending & finishing, deburring, surface prep, finishing and cleaning
- Heavy duty dual taper 200 Series Collet provides a secure clamp load and delivers superior run out characteristics



Description	Stock No.	Free Speed RPM	Collet Size	Exhaust	Weight lbs (kg)	Length in (mm)	Sound Level dB(A)	Maximum Air Consumption scfm (l/s)
0.70 hp (0.52 kw) - Straight Die Grinders Lever Throttle	SDG7S25F	25,000	1/4"	Front	1.2 (0.6)	6 (150)	82	25 (12)
	SDG7S18F	18,000	1/4"	Front	1.2 (0.6)	6 (150)	82	25 (12)
	SDG7S25M6F	25,000	6mm	Front	1.2 (0.6)	6 (150)	82	25 (12)
	SDG7S18M6F	18,000	6mm	Front	1.2 (0.6)	6 (150)	82	25 (12)
1 hp (0.75 kw) - Straight Die Grinders Lever Throttle	SDG10S25F	25,000	1/4"	Front	1.7 (0.8)	7.5 (190)	78	30 (14)
	SDG10S18F	18,000	1/4"	Front	1.7 (0.8)	7.5 (190)	78	30 (14)
	SDG10S12F	12,000	1/4"	Front	1.7 (0.8)	7.5 (190)	78	30 (14)
	SDG10S25R	25,000	1/4"	Rear	1.7 (0.8)	7.5 (190)	78	30 (14)
	SDG10S18R	18,000	1/4"	Rear	1.7 (0.8)	7.5 (190)	78	30 (14)
	SDG10S12R	12,000	1/4"	Rear	1.7 (0.8)	7.5 (190)	78	30 (14)
	SDG10S25M6F	25,000	6mm	Front	1.7 (0.8)	7.5 (190)	78	30 (14)
	SDG10S18M6F	18,000	6mm	Front	1.7 (0.8)	7.5 (190)	78	30 (14)
	SDG10S12M6F	12,000	6mm	Front	1.7 (0.8)	7.5 (190)	78	30 (14)
	SDG10S25M6R	25,000	6mm	Rear	1.7 (0.8)	7.5 (190)	78	30 (14)
	SDG10S18M6R	18,000	6mm	Rear	1.7 (0.8)	7.5 (190)	78	30 (14)
	SDG10S12M6R	12,000	6mm	Rear	1.7 (0.8)	7.5 (190)	78	30 (14)
1 hp (0.75 kw) - Straight Die Grinders Lever Throttle - Extended	STXG10S23	23,000	1/4"	Rear	2.2 (1.0)	12.1 (308)	78	30 (14)
	STXG10S18	18,000	1/4"	Rear	2.2 (1.0)	12.1 (308)	78	30 (14)
	STXG10S12	12,000	1/4"	Rear	2.2 (1.0)	12.1 (308)	78	30 (14)
	STXG10S23M6	23,000	6mm	Rear	2.2 (1.0)	12.1 (308)	78	30 (14)
	STXG10S18M6	18,000	6mm	Rear	2.2 (1.0)	12.1 (308)	78	30 (14)
	STXG10S12M6	12,000	6mm	Rear	2.2 (1.0)	12.1 (308)	78	30 (14)
1 hp (0.75 kw) - Right Angle Die Grinders Lever Throttle	SAG10S12	12,000	1/4"	Rear	2.7 (1.2)	9.0 (230)	78	30 (14)
	SAG10S15	15,000	1/4"	Rear	2.7 (1.2)	9.0 (230)	78	30 (14)
	SAG10S18	18,000	1/4"	Rear	2.7 (1.2)	9.0 (230)	78	30 (14)
	SAG10S12M6	12,000	6mm	Rear	2.7 (1.2)	9.0 (230)	78	30 (14)
	SAG10S15M6	15,000	6mm	Rear	2.7 (1.2)	9.0 (230)	78	30 (14)
	SAG10S18M6	18,000	6mm	Rear	2.7 (1.2)	9.0 (230)	78	30 (14)

Performance

- Powerful motors deliver consistent power and working speeds (from 12-25,000 RPM) for heavy loads
- Heavy-duty dual-taper collets provide secure clamp loads and deliver superior run out characteristics
- Responsive Teasing Throttles provide excellent control
- Precision Machined Heat Treated Spiral Bevel Gears for smooth operation and maximum life

Ergonomics

- Comfortable, compact tool bodies measure only 1.67" (43mm) in diameter
- Contoured safety levers and ergonomic composite handles with textured grips
- Low noise and vibration levels for comfort in extended use operations

Serviceability

- Drop in motors with no alignment required
- No press fits & no shims = quick easy maintenance
- High part interchangeability = lower service part inventories

All Sioux Signature Series Die Grinders (SDG/SAG/STXG Series) use a heavy duty dual-taper 200 Series collet which provides a secure clamp load and delivers superior run out characteristics.





HEAVY-DUTY GRINDERS

INDUSTRIAL POWER TOOLS



Right Angle Type 27 Wheel Grinders with Lockoff Lever Throttle

- Full 1HP air motor maintains power under load
- Heavy duty gearing for increased life
- Light weight aluminum reinforced nylon housing
- Ergonomic composing handle with soft textured grip
- Side handle can be positioned for left or right handed operators
- Teasing throttle for exceptional control

CE

Description	Stock No.	Free Speed RPM	Wheel Capacity in. (mm)		Weight lbs (kg)		Length in (mm)		Sound Level dB(A)	Air Consumption Under Load cfm (l/s)		Air Consumption Free Speed cfm (l/s)		Spindle Thread
1 hp (0.75 kw)	SWG10S183	18,000	3.0	75	2.5	1.1	7.5	190	77	N/A	N/A	35	17	½"-24
	SWG10S124	12,000	4.0	100	3.0	1.6	8.3	210	77	N/A	N/A	35	17	½"-24
	SWG10S1245	12,000	4.5	115	3.0	1.6	8.3	210	77	N/A	N/A	35	17	½"-11
1 hp (0.75 kw) - Governed Speed	1285L*	6,000	7.0	175	5.9	2.7	12.4	315	85	35	17	18	8	½"-11

* NOTE: 1285L is not CE approved



Vertical and Horizontal Wheel Grinders, Governed Speed with Lever Throttle

- Three piece housing construction for ease of maintenance
- Governor controlled
- Lock off lever prevents accidental start up

CE

Description	Stock No.	Free Speed RPM	Wheel Capacity in (mm)	Weight (without guard) lb (kg)	Height (Vertical) Length (Horizontal) in (mm)	Sound Level dB(A)	Air Consumption Under Load cfm (l/s)	Air Consumption Free Speed cfm (l/s)	Spindle Thread
Vertical Type 6 & 11 - 2 hp (1.5 kw)	VG20AL-60C6	6000	6 (150)	7.4 (3.3)	5.5 (145)	85	75 (35)	26 (12)	½"-11
Vertical Type 6 & 11 - 3 hp (2.2 kw)	VG30AL-60C6	6000	6 (150)	9.5 (4.3)	6.4 (165)	84	90 (42)	39 (18)	½"-11
Vertical Type 27 - 2 hp (1.5 kw)	VG20AL-60D7	6000	7 (175)	7.4 (3.3)	5.5 (145)	85	75 (35)	26 (12)	½"-11
	VG20AL-45D9	4500	9 (230)	7.4 (3.3)	5.5 (145)	85	75 (35)	26 (12)	½"-11
	VG20AL-60D9	6000	9 (230)	7.4 (3.3)	5.5 (145)	85	75 (35)	26 (12)	½"-11
Vertical Type 27 - 3 hp (2.2 kw)	VG30AL-60D7	6000	7 (175)	9.5 (4.3)	6.4 (165)	84	90 (42)	39 (18)	½"-11
	VG30AL-45D7	4500	7 (175)	9.5 (4.3)	6.4 (165)	84	90 (42)	39 (18)	½"-11
	VG30AL-45D9	4500	9 (230)	9.5 (4.3)	6.4 (165)	84	90 (42)	39 (18)	½"-11
	VG30AL-60D9	6000	9 (230)	9.5 (4.3)	6.4 (165)	84	90 (42)	39 (18)	½"-11
Horizontal 2 hp (1.5 kw)	HG20AL-60S6	6000	6 (150)	10.5 (4.8)	20.8 (530)	85	75 (35)	26 (12)	½"-11
	HG20AL-45S8	4500	8 (200)	10.5 (4.8)	20.8 (530)	85	75 (35)	26 (12)	½"-11
	HG20AL-80P3	8000	3 (75)	10.5 (4.8)	20.8 (530)	85	75 (35)	26 (12)	½"-11
Horizontal 3 hp (2.2 kw)	HG30AL-60S6	6000	6 (150)	12.5 (5.6)	21.8 (550)	84	90 (42)	39 (18)	½"-11
	HG30AL-45S8	4500	8 (200)	12.5 (5.6)	21.8 (550)	84	90 (42)	39 (18)	½"-11
	HG30AL-80P3	8000	3 (75)	12.5 (5.6)	21.8 (550)	84	90 (42)	39 (18)	½"-11

<p>What are the benefits of a Governed Motor?</p> <ul style="list-style-type: none"> • Governed motors maintain maximum working RPMs and provide more power at higher speed. • Governed motors require less air and control the speed of the wheel, preventing overspeed. 	<p>What does the user gain?</p> <ul style="list-style-type: none"> • Improved productivity and enhanced operator safety. • Increased abrasive efficiency and improved service life of consumables. • Result? Reduced cost.
--	--



- Must wear eye protection
- Read safety precautions on pages W1 to W2

CHISEL AND NEEDLE SCALERS



SC41011AL-C



SC41011AU-N5



SC80910AL-C



Square Shank and Octagon Shank Scalers

- Available with lever or push pull style throttle
- SC4 Series accepts square shank chisels
- SC8 series accepts octagon chisels
- Adjustable housing allows the operator to vary the length of the exposed needles

CE

Stock No.	Type	Shank	Throttle	Stroke Length in (mm)	Bore Diameter in (mm)	Blows per Minute	Weight lb (kg)	Length in (mm)	Side to Center in (mm)	Air Consumption scfm (l/s)
SC80910AL-C	Chisel	Octagon	Lever	1.0 (25)	1 ¹ / ₈ (23)	4300	4.0 (1.7)	15.0 (375)	0.8 (20)	12.0 (6)
SC80910AL-N5	Needle	Octagon	Lever	1.0 (25)	1 ¹ / ₈ (23)	4300	6.2 (2.7)	17.0 (425)	0.9 (23)	12.0 (6)
SC41011AL-C	Chisel	Square	Lever	1.1 (28)	1.0 (25)	4600	4.6 (2.1)	10.5 (263)	0.9 (23)	12.0 (6)
SC41011AU-C	Chisel	Square	Push-Pull	1.1 (28)	1.0 (25)	4600	4.6 (2.1)	12.0 (300)	0.9 (23)	12.0 (6)
SC41011AL-N5	Needle	Square	Lever	1.1 (28)	1.0 (25)	4600	6.3 (2.9)	15.3 (383)	1.0 (25)	12.0 (6)
SC41011AU-N5	Needle	Square	Push-Pull	1.1 (28)	1.0 (25)	4600	6.3 (2.9)	16.8 ()	1.0 (25)	12.0 (6)



SC41011AL-K



SC80910AL-K

SC41011AL-K SC4 Square Shank Scaler Kit

Includes:

- SC4 Lever Needle Scaler
- Additional Set of Needles
- 3/8" x 7" Flat Chisel
- 1-3/8" x 7" Flat Chisel
- 1-3/8" x 7" Spoon Chisel
- Custom Carrying Case

SC80910AL-K SC8 Octagon Shank Scaler Kit

Includes:

- SC8 Needle Scaler
- Additional Set of Needles
- 3/8" x 7" Flat Chisel
- 1-3/8" x 7" Flat Chisel
- 1-3/8" x 7" Spoon Chisel
- Custom Carrying Case



IMPACT WRENCHES



Thru-hole anvil for maximum socket security



3/4"



1"

Square drive Thru-hole anvil



IW75BP-6H

Sioux Industrial-Duty Pistol Grip Impact Wrenches

- Thru-Hole Anvil for positive socket retention
- Three piece housing construction for ease of maintenance
- Two jaw impact mechanism
- Aluminum handle with steel hammer case
- Suspension bail included
- Down handle exhaust directs air away from the operator
- Conveniently located reverse

CE

Stock No.	Drive Size in (mm)	Bolt Cap. Grade 5 in (mm)	Working Torque Range ¹ ft lb (Nm)	Maximum Torque ft lb (Nm)	Blows Per Minute	Free Speed RPM	Weight lb (kg)	Length in (mm)	Side To Center in (mm)	Avg Air Consumption cfm (l/s)
IW75BP-6H	3/4 (19)	3/4 (19)	800 (1085)	1000 (1356)	1000	5700	11.6 (5.3)	7.6 (193)	1.75 (45)	15 (7)
IW75BP-8H	1 (25)	3/4 (19)	825 (1119)	1100 (1492)	1000	5700	11.7 (5.3)	7.6 (193)	1.75 (45)	15 (7)

¹Maximum working torque determined by 5-second rundown on appropriate Skidmore-Wilhelm Torque-Tension Tester

Sioux Industrial-Duty D-Handle Impact Wrenches

- Thru-Hole Anvil for positive socket retention
- 3 piece housing construction for ease of maintenance
- Thru-Hole Anvil for positive socket retention
- Aluminum housing with steel hammer case
- Available with inside or outside trigger
- Conveniently located reverse
- Front exhaust directs air away from the operator
- Side handle included
- Available with 1", 1 1/2" and #5 spline anvils and 6" extended anvils



1"



1-1/2"

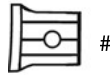

#5 Spline

Square drive and Spline Thru-hole anvil



IW100HAI-8H

CE

Description	Stock No.	Drive Size in (mm)	Bolt Cap. Grade 5 in (mm)	Working Torque Range ¹ ft lb (Nm)	Maximum Torque ft lb (Nm)	Blows Per Minute	Free Speed RPM	Weight lb (kg)	Length in (mm)	Side To Center in (mm)	Avg Air Consumption cfm (l/s)
Inside Trigger	IW100HAI-8H	1 (25)	1 3/8 (35)	1600 (2170)	2000 (2710)	850	5000	22.0 (10.0)	12.4 (315)	2 (51)	38 (18)
	IW100HAI-5S	#5 Spline	1 3/8 (35)	1600 (2170)	2000 (2710)	850	5000	22.0 (10.0)	12.4 (315)	2 (51)	38 (18)
	IW150HAI-12H	1 1/2 (38)	2 (50)	2500 (3390)	3000 (4070)	650	3750	33.1 (15.0)	14.5 (368)	2.5 (65)	60 (28)
	IW150HAI-5S	#5 Spline	2 (50)	2500 (3390)	3000 (4070)	650	3750	33.1 (15.0)	14.5 (368)	2.5 (65)	60 (28)
Inside Trigger - with 6" Extended Anvil	IW100HAI-8H6	1 (25)	1 3/8 (35)	1600 (2170)	2000 (2710)	850	5000	26.2 (11.8)	18.4 (467)	2 (51)	38 (18)
	IW100HAI-5S6	#5 Spline	1 3/8 (35)	1600 (2170)	2000 (2710)	850	5000	26.2 (11.8)	18.4 (467)	2 (51)	38 (18)
Outside Trigger	IW100HAO-8H	1 (25)	1 3/8 (35)	1600 (2170)	2000 (2710)	850	5000	22.0 (10.0)	12.4 (315)	2 (51)	38 (18)
	IW100HAO-5S	#5 Spline	1 3/8 (35)	1600 (2170)	2000 (2710)	850	5000	22.0 (10.0)	12.4 (315)	2 (51)	38 (18)
	IW150HAO-12H	1 1/2 (38)	2 (50)	2500 (3390)	3000 (4070)	650	3750	33.1 (15.0)	14.5 (368)	2.5 (65)	60 (28)
	IW150HAO-5S	#5 Spline	2 (50)	2500 (3390)	3000 (4070)	650	3750	33.1 (15.0)	14.5 (368)	2.5 (65)	60 (28)
Outside Trigger - with 6" Extended Anvil	IW100HAO-8H6	1 (25)	1 3/8 (35)	1600 (2170)	2000 (2710)	850	5000	26.2 (11.8)	18.4 (467)	2 (51)	38 (18)
	IW100HAO-5S6	#5 Spline	1 3/8 (35)	1600 (2170)	2000 (2710)	850	5000	26.2 (11.8)	18.4 (467)	2 (51)	38 (18)

¹Maximum working torque determined by 5-second rundown on appropriate Skidmore-Wilhelm Torque-Tension Tester



- Must wear eye protection
- Read safety precautions on pages W1 to W2

HYDRAULIC PUMPS



JHW5HS2S35

Hand Pumps

- **JHW5HS2S35, JHW5HS2S100 and JHW5HS2S200** feature 2 speed operation
- Pressure relief valve for overload protection
- Load release valve for single acting cylinder usage

Used with Cylinder	Pump Type	Usable Oil Capacity (in ³)	Stock No.	Pressure Rating (psi)		Oil Displacement per Stroke (in ³)		Max. Operating Force (lbs)	Piston Stroke (in)	Oil Outlet Port
				1st Stage	2nd Stage	1st Stage	2nd Stage			
Single Acting	Single-speed	36.5	JHW5HS1S60	200	10,000	0.18	0.05	109	0.79	3/8"-18NPTF
		67.0	JHW5HS1S120					89	0.82	3/8"-18NPTF
	21.4	JHW5HS2S35	88					0.38	1/4"-18NPTF	
	61.0	JHW5HS2S100	132					0.82	3/8"-18NPTF	
	128.0	JHW5HS2S200								



JHW5E10H2G

Electric Pumps

- Quiet operation meets OSHA regulations (80dBA)
- 2 speed operation allows for faster cylinder advance
- Full load starting capacities
- Internal filter keeps contamination from damaging pump
- Ideal for on site construction as well as maintenance

Motor Size (hp)	Usable Oil Capacity (gal)	Stock No.	Stock No. with Remote Control Pendant Switch	Max. Output Pressure (psi)	Oil Output Flow Rate (in ³)		Valve Type	Valve Function	Current Draw (amps)	Motor Voltage (volts)	Sound Level (dBA)
					1st Stage	2nd Stage					
0.5	1.0	JHW5E05H1G	JHW5E05H1GR	10,000	293	18	4-way, 3-pos.	Advance Hold Return	8	115	80
1.0	2.0	JHW5E10H2G	JHW5E10H2GR	10,000	311	37	4-way, 3-pos.	Advance Hold Return	15	115	80
1.5	3.0	JHW5E15H3G	JHW5E15H3GR	10,000	470	61	4-way, 3-pos.	Advance Hold Return	17	115	80



JHW5AS150







JHW5AS380L

Air Pumps

- High strength reinforced aluminum alloy reservoir is lightweight and corrosion resistant
- Pressure relief valve for overload protection
- Suggested air pressure range: 90-175 psi / 6-12 bar
- Designed to be used with single acting cylinders
- JHW5AS200 offers a turbo function that features high flow at high pressure condition
- JHW5AD150M offers a 4-way control valve for operation of double acting cylinders
- Maximum working pressure: 10,000 psi / 700 bar

Used with Cylinder	Usable Oil Capacity (in ³)	Stock No.	Pressure Rating (psi)	Oil Output Flow Rate (in ³ /min)		Input Air Pressure Range (psi)
				No Load	Load	
Single Acting	36.6	JHW5AS60	10,000	61	9	100-200
	91.5	JHW5AS150	10,000	66	11	100-200
	122.1	JHW5AS200	10,000	65	12	100-200
	231.9	JHW5AS380	10,000	65	11	100-200
	91.5	JHW5AS150L	10,000	61	10	100-200
	231.9	JHW5AS380L	10,000	61	10	100-200
Double Acting	91.5	JHW5AD150M	10,000	66	11	100-200





Air Pump and Single-Acting Cylinder Matching Chart

Capacity (Tons) Stroke (in)	5	10	15	25	30	55	75	100
<1.00								
1.00								
2.00								
3.00								
4.00								
5.00								
6.00								
7.00								
8.00								
9.00								
10.00								
12.00								
13.00								
14.00								
	 JHW5AS60		 JHW5AS150			 JHW5AS380		

Note: Selection based on oil capacity requirements of cylinders.

 Not Recommended

Hand Pump/E-Pump and Single-Acting Cylinder Matching Chart

Capacity (Tons) Stroke (in)	5	10	15	25	30	55	75	100
sdf<1.00								
1.00								
2.00								
3.00								
4.00								
5.00								
6.00								
7.00								
8.00								
9.00								
10.00								
12.00								
13.00								
14.00								
	 JHW5HS2S35	 JHW5HS2S100	 JHW5HS2S200		 JHW5E10H2G			

Note: Selection based on oil capacity requirements of cylinders.



- Must wear eye protection
- Read safety precautions on pages W1 to W2

Single Acting Cylinders

- 39 models
- Internal plunger threads
- Snap in grooved saddles
- Rod wiper seals out dirt and contamination
- Collar fixture threads
- Two base mounting holes on most models
- High strength steel construction from gun drilled solid bar
- High flow 3/8" NPTF couplers
- Collar thread protector
- One piece high grade alloy bearing for side load protection and long life
- Polyurethane cup seal provides optimum performance
- Industrial hard chrome plated ram helps prevent rust and corrosion
- Solid steel cylinder body
- Heavy duty return spring provides quicker retraction
- Ideal for lifting and pressing
- Maximum working pressure: 10,000 psi / 700 bar



JHW6C05T05



JHW6C55T06

Cylinder Capacity (tons)	Stroke (in)	Stock No.	Cylinder Effective Area (in ²)	Pressure at Capacity (psi)	Oil Capacity (in ³)	Collapsed Height (in)
5	0.63	JHW6C05T00	1.10	10,000	0.69	1.61
	1.00	JHW6C05T01	1.00		1.00	4.58
	3.07	JHW6C05T03			3.07	6.65
	5.08	JHW6C05T05			5.08	8.70
	7.09	JHW6C05T07			7.09	10.71
	9.09	JHW6C05T09			9.09	12.72
10	1.00	JHW6C10T01	2.24	8,930	2.24	3.62
	2.01	JHW6C10T02			4.50	4.84
	4.02	JHW6C10T04			9.00	6.85
	5.94	JHW6C10T06			13.31	9.84
	7.95	JHW6C10T08			17.81	11.85
	9.96	JHW6C10T10			22.31	13.86
	11.97	JHW6C10T12			26.81	15.87
14.02	JHW6C10T14	31.40	17.72			
15	0.99	JHW6C15T01	3.14	9,550	3.11	4.88
	2.01	JHW6C15T02			6.31	5.87
	3.98	JHW6C15T04			12.50	7.87
	5.87	JHW6C15T06			18.43	10.67
	7.87	JHW6C15T08			24.71	12.68
	9.88	JHW6C15T10			31.02	14.69
	12.01	JHW6C15T12			37.71	16.65
14.02	JHW6C15T14	44.02	18.66			
25	1.02	JHW6C25T01	5.14	9,730	5.24	5.84
	2.01	JHW6C25T02			10.33	6.82
	3.94	JHW6C25T04			20.25	8.78
	5.94	JHW6C25T06			30.53	10.79
	7.95	JHW6C25T08			40.86	12.80
	9.96	JHW6C25T10			51.19	14.80
	12.24	JHW6C25T12			62.91	16.73
	14.25	JHW6C25T14			73.25	18.74
30	8.27	JHW6C30T08	6.49	9,240	53.67	15.24
55	2.01	JHW6C55T02	10.99	10,000	22.09	6.93
	3.98	JHW6C55T04			43.74	8.94
	6.22	JHW6C55T06			68.36	11.14
	13.27	JHW6C55T13			145.84	18.15
75	6.14	JHW6C75T06	16.10	9,320	98.85	11.22
	13.11	JHW6C75T13			211.07	19.37
100	6.61	JHW6C100T06	20.57	9,720	135.97	14.06
	10.24	JHW6C100T13			210.64	17.68



3M05T75

3M05T150

3M10T160

Mini Jacks

- Low profile mini jack
- Pocket size and lightweight
- Convenient for storage
- Interchangeable saddle on model 3M05T75 and 3M05T150.

Capacity (tons)	Stock No.	Minimum Height (in)	Maximum Height (in)	Hydraulic Lifting (in)	Base Size (L x W) (in)	Weight (lbs)
5	3M05T75	2.37	3.13	0.76	4.13 x 4.00	4.6
	3M05T150	3.37	4.88	1.51	4.13 x 4.00	5.3
10	3M10T160	4.75	6.25	1.63	4.88 x 4.38	12.5
20	3M20T160	5.13	6.75	1.63	5.38 x 4.75	16.7



- Must wear eye protection
- Read safety precautions on pages W1 to W2



Maintenance Kits

- Sets are portable for easy use in the plant or on the job site
- Custom fitted, rugged blow molded storage case
- 10 ton set case has wheels for easy movement
- Designed for applications of pushing, spreading, pressing and more
- Pumps are rated from 8,000 to 10,000 psi

Capacity (tons)	Stock No.	Ram Specifications		Number of Attachments
		Collapsed Height (in)	Extended Height (in)	
4	JHW4M04T	11.00	15.75	14
10	JHW4M10T	13.63	19.75	13

NOTE: capacity may be reduced when extension tubes and attachments are used

Maintenance Kit Contents:

Stock No.	JHW4M04T	JHW4M10T
Hand Pump	X	X
Ram	X	X
Hose Assembly	X	X
Hose Coupler	X	X
Ram Coupler	X	X
Case	X	X
Hydraulic Spreader	X	X
Combination Head	X	X
Rubber Head	X	X
Ram Toe	X	X
Plunger Toe	X	X
Flat Base	X	X
Serrated Saddle	X	X
Wedge Head	X	X
Male Connector	X	X
Extension Tubes Included:	3"	4"
	6 1/2 "	10"
	8 1/2 "	18"
	16 1/2 "	27"

Side Pump Bottle Jacks

- Hydraulic system is protected from internal damage by a patented by-pass mechanism
- Machined and polished cylinders with die-cut threads provide non-abrasive leak-free, durable performance
- Fabricated from hard-cast steel with heat-treated critical stress areas
- Serrated heat-treated saddle provides generous lifting area and secure grip
- Heat-treated extension screw allows low pick-up height adjustment and maximum lift height
- U.S. patented built-in by-pass device protects hydraulic system from overpumping damage
- Unique cross-type forged release valve assures positive control
- A wide, rugged base provides stability and strength
- Critical stress points are reinforced in all models for added durability and dependability
- Economically priced for maximum value



JHW3S12TV

Capacity (tons)	Stock No.	Min Height (in)	Max. Height (in)	Extension Screw (in)	Hydraulic Lifting (in)	Base Size (LxW)Inches
12	JHW3T12TV	9.5	18.63	3.13	6	5.25 x 5.13
12	JHW3S12TV	6	10.63	1.63	3	5.25 x 5.13
20	JHW3T20TV	9.5	18.63	3.13	6	6.25 x 5.88
20	JHW3S20TV	6.5	11.25	1.63	3.13	6.25 x 5.88



JHW4T10T

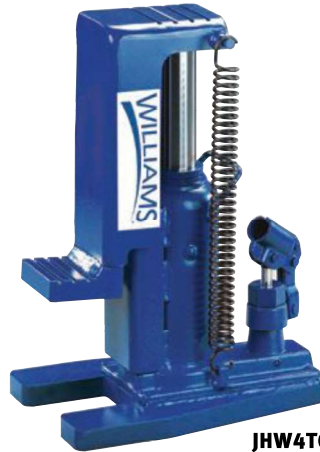

JHW4T06T

Toe Jacks

- Heat treated and chrome plated medium-carbon steel cylinder
- Chrome plated ram promotes longer seal life and optimum performance
- U.S. Patented by-pass device protects hydraulic system from over traveling damage

Capacity (tons)	Stock No.	Toe Saddle		Head Saddle		Hydraulic Lift (in)
		Min Height (in)	Max. Height (in)	Min Height (in)	Max height (in)	
6	JHW4T06T	.88	6.00	10.50	15.63	5.13
10	JHW4T10T	1.13	6.25	11.00	16.13	5.13

Flat Body Cylinder Kits

- Kits include a variety of height magnetic adapters
- Perfect for low clearance areas needing a cylinder height boost
- Maximum working pressure: 10,000 psi / 700 bar
- Kits include magnetic adapters and carrying case
- Cylinders may be ordered separately

JHW6CF05T03TB



Cylinder Capacity (tons)	Stroke (in)	Complete Kit Stock No.	Cylinder Model	Oil Capacity (in ³)	Collapsed Height (in)
5	0.24	JH6CF05T03TB	JHW6CF05T03	0.26	1.26
10	0.43	JH6CF10T05TB	JHW6CF10T05	1.01	1.69
20	0.43	JH6CF20T05TB	JHW6CF20T05	1.88	2.01
30	0.51	JH6CF30T05TB	JHW6CF30T05	3.31	2.31
50	0.63	JH6CF50T05TB	JHW6CF50T05	6.21	2.64

Flat Body Cylinder Mounting Hole Dimensions

- Made of high quality steel
- Extremely low collapsed height for applications with minimal clearance at the lift point
- Great for areas of low clearance
- Maximum working pressure 10,000 psi / 700 bar



JHW6CF05T03

Stock No.	Hole Pitch (in)	Counter Bore Dia. (in)	Counter Bore Depth (in)	Min Height (in)
JHW6CF05T03	1.12	0.31	0.17	0.17
JHW6CF10T05	1.44	0.42	0.31	0.31
JHW6CF20T05	1.94	0.59	0.39	0.39
JHW6CF30T05	2.06	0.62	0.44	0.44
JHW6CF50T05	2.62	0.75	0.50	0.43



- Must wear eye protection
- Read safety precautions on pages W1 to W2

HYDRAULIC SPREADERS AND PRESSES

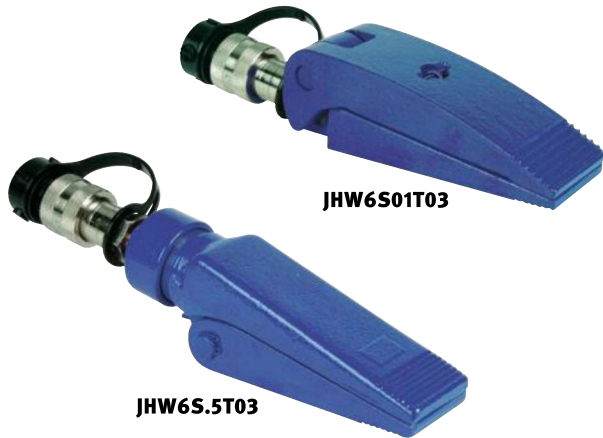

Spreaders

- Designed to operate in confined space where expansion is needed
- Compact size makes for easy use in hard to reach places
- Positive over travel stops and return spring
- Connects directly to pump hose with high flow coupler
- Maximum working pressure: 10,000 psi/ 700 bar

Cylinder Capacity (tons)	Stock No.	Cylinder Effective Area (in ²)	Oil Capacity (in ³)
0.5	JHW6S.5T03	1.22	0.58
1	JHW6S01T03	1.09	0.86



55/100 Ton Shop Presses

- Heavy steel welded construction
- Multi-position bed for work height adjustment
- Ideal for the removal or installation of gears, universal joints, pulleys, wrist pins, and other press jobs
- Excellent for bending, bonding or straightening applications

Capacity (tons)	Stock No.	Pump Type	Pump Model
55	JHW9A55T06	Air	JHW5AS150
	JHW9E55T06	Electric	JHW5E05H1GR
	JHW9H55T06	Manual	JHW5HS2S200
	JHW9A55T13	Air	JHW5AS380
	JHW9E55T13	Electric	JHW5E05H1GR
100	JHW9E100T10	Electric	JHW5E10H2GR

Gauges

Gauge Type	Stock No.	Face Dia. (in)	Thread (in)	Pressure Range		Graduation			
						Major Graduation	Minor Graduation	Major Graduation	Minor Graduation
				(psi)	(bar)	(psi)		(bar)	
Wet	JHW8G025W	2.50	1/2"-18NPTF	0-10,000	0-700	1,000	100	100	10
	JHW8G04W	4.00				2,000	200		



JHW8G04W

Gauge Adaptors

Stock No.	A (in)	B (in)	C (in)	D (in)	E (in)	F (in)
JHW8FG38MF	5.12	1.38	1/4"-18NPTF	3/8"-18NPTF	3/8"-18NPTF	1.25



JHW8FG38MF

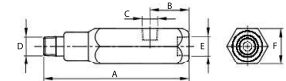

Adapters

Stock No.	Description	Male Thread	Female Thread	Dimensions (in)	
		C	D	A	B
JHW8FR38M25F	Adapter	1/4"-18NPTF	3/8"-18NPTF	1.39	0.91
JHW8FB25F38M	Bushing	3/8"-18NPTF	1/4"-18NPTF	0.87	0.67



JHW8FB25F38M



JHW8FR38M25F

Hydraulic Hoses

Stock No.	Hose I.D. (in)	Hose End Fittings	Operating Pressure (psi)	Hose Length (ft)	Weight (lbs)
JHW8H2525D06	1/4"	1/4"-18NPTF	10,000	6	2.5
JHW8H3825D06				6	3.0
JHW8H3825D10		3/8"-18NPTF		10	5.0
JHW8H3825D20				20	10.5
JHW8H2538D06	3/8"	1/4"-18NPTF		6	3.2
JHW8H3838D06				6	3.5
JHW8H3838D10		3/8"-18NPTF		10	6.5
JHW8H3838D20				20	13.5



JHW8H2525D06

Hydraulic Oil

Stock No.	Volume (gal)	Viscosity Index (min)	Viscosity @ 100°F (S.U.S.)	Viscosity @ 210°F (S.U.S.)	ASTM Grade	Flash Point (°F)	Pour Point (°F)	API Gravity
JHW8H1G	1	168	215	47	215	410	-54	31.4



JHW8H1G

Couplers

Coupler Type	Stock No.		
	Complete Set	Male Half	Female Half
High-Flow Coupler	JHW8RH38D	JHW8RH38DM	JHW8RH38DF
Regular-Flow Coupler	JHW8R38D	JHW8R38DM	JHW8R38DF



JHW8RH38DM



JHW8R38D



JHW8RH38D

Couplings/Male Connectors

Stock No.	Type	Dimensions			
		A (in)	B (in)	C	D
8FC25F38F	Couplings	1.18	1.02	Female 1/4"-18NPTF	Female 3/8"-18NPTF
8FC38F	Couplings	1.18	1.02	Female 3/8"-18NPTF	Female 3/8"-18NPTF
8FN25M	Male Connectors	1.50	0.67	Male 1/4"-18NPTF	Male 1/4"-18NPTF
8FN38M	Male Connectors	1.50	0.75	Male 3/8"-18NPTF	Male 3/8"-18NPTF
8FN25M38M	Male Connectors	1.45	0.75	Male 1/4"-18NPTF	Male 3/8"-18NPTF



8FC38F



8FN38M



8FN25M38M



• Must wear eye protection
• Read safety precautions on pages W1 to W2

HYDRAULIC PUMPS AND CYLINDERS



Additional sizes and styles, including aluminum cylinders, are available. Contact your Snap-on Industrial Representative or Customer Service for more information about Enerpac hydraulic equipment.

Single Acting RC-Series Cylinders

- For most lifting applications
- Designed for use in all positions
- ENECR400 Coupler and Dust Cap included on all models

Stock No.	Cylinder Capacity (tons)	Stroke (in)	Oil Capacity (cu.in.)	Collapsed Height (in)	Weight (lbs)
ENERC50	5	0.63	0.62	1.63	2.2
ENERC51	5	1	0.99	4.34	2.3
ENERC53	5	3	2.98	6.5	3.3
ENERC55	5	5	4.97	8.5	4.1
ENERC57	5	7	6.96	10.75	5.3
ENERC59	5	9.13	9.07	12.75	6.1
ENERC101	10	1	2.24	3.53	4
ENERC102	10	2.13	4.75	4.78	5.1
ENERC104	10	4.13	9.23	6.75	7.2
ENERC106	10	6.13	13.7	9.75	9.8
ENERC108	10	8	17.89	11.75	12
ENERC1010	10	10.13	22.65	13.75	14
ENERC1012	10	12	26.84	15.75	15
ENERC1014	10	14	31.31	17.75	18
ENERC151	15	1	3.14	4.88	7.2
ENERC152	15	2	6.28	5.88	9
ENERC154	15	4	12.57	7.88	11
ENERC156	15	6	18.85	10.69	15
ENERC158	15	8	25.13	12.69	18
ENERC1510	15	10	31.42	14.69	21
ENERC1512	15	12	37.7	16.69	24
ENERC1514	15	14	43.98	18.69	26
ENERC251	25	1	5.16	5.5	13
ENERC252	25	2	10.31	6.5	14
ENERC254	25	4	20.63	8.5	18
ENERC256	25	6.25	32.23	10.75	22
ENERC258	25	8.25	42.55	12.75	27
ENERC2510	25	10.25	52.86	14.75	31
ENERC2512	25	12.25	63.18	16.75	36
ENERC2514	25	14.25	73.49	18.75	39
ENERC308	30	8.25	53.56	15.25	40
ENERC502	50	2	22.09	6.94	33
ENERC504	50	4	44.18	8.94	42
ENERC506	50	6.25	69.03	11.13	51
ENERC5013	50	13.25	146.34	18.13	83
ENERC756	75	6.13	97.41	11.25	65
ENERC7513	75	13.13	208.74	19.38	130
ENERC1006	100	6.63	136.67	14.06	130
ENERC10010	100	10.25	211.45	17.69	160



In addition to the offering shown here, Snap-on Industrial offers Enerpac's full line of hydraulic tools & equipment

Single Acting Pump and Cylinder Sets

- Optimum match of individual components
- All sets include cylinder, hand or air pump, 6' safety hose, calibrated gauge and gauge adaptor
- The quickest and easiest way to start working right away

Stock No.	Set Capacity (tons)	Cylinder Stroke Length (in)	Pump Type Included
ENESCR55H	5	5	Two-Speed Hand
ENESCR102H	10	2.13	Two-Speed Hand
ENESCR106H	10	66.13	Two-Speed Hand
ENESCR154H	15	4	Two-Speed Hand
ENESCR156H	15	6	Two-Speed Hand
ENESCR252H	25	2	Two-Speed Hand
ENESCR254H	25	4	Two-Speed Hand
ENESCR256H	25	6.25	Two-Speed Hand
ENESCR2514H	25	14.25	Two-Speed Hand
ENESCR506H	50	6.25	Two-Speed Hand
ENESCR1006H	100	6.63	Two-Speed Hand

RCH-Series Hollow Cylinders

- Versatile: for testing, maintenance, and tensioning applications
- Hollow plunger design allows for both pull and push forces
- Nickel-plated, floating center tube on models over 20 tons
- ENERCH121 has ENEFZ1630 Reducer and ENEAR630 Coupler, all other models feature ENECR400 Coupler

Cylinder Capacity (tons)	Stroke (in)	Stock No.	Oil Capacity (cu.in.)	Collapsed Height (in)	Weight (lbs)
12	0.31	ENERCH120	0.86	2.19	3
12	1.63	ENERCH121	4.49	4.75	6
12	3.00	ENERCH123	8.29	7.25	10
20	2.00	ENERCH202	9.46	6.38	17
20	6.10	ENERCH206	28.67	12.05	31
30	2.50	ENERCH302	18.05	7.03	24
30	6.13	ENERCH306	44.23	13.00	48
60	3.00	ENERCH603	38.2	9.75	62
60	6.00	ENERCH606	76.41	12.75	78



Flat and Low Height Cylinders

RSM-Series Flat-Jac® Cylinders

- Compact, flat design for use where other cylinders will not fit
 - Stroke is less than 1"
 - ENERSM1000 includes handle
 - ENECR400 Coupler and Dust Cap included on all models
- RCS-Series Low Height Cylinders**
- Lightweight, low profile design for use in confined spaces
 - Stroke range: 1.50 to 2.25"
 - ENECR400 Coupler and Dust Cap included on all models
 - ENERCS1002 includes handle

	Stock No.	Cylinder Capacity (tons)	Stroke (in)	Oil Capacity (cu.in.)	Collapsed Height (in)	Weight (lbs)
RSM-Series Flat-Jac® Cylinders	ENERSM50*	5	0.25	0.25	1.28	2.3
	ENERSM100	10	0.44	0.98	1.69	3.1
	ENERSM200	20	0.44	1.94	2.03	6.8
	ENERSM300	30	0.5	3.25	2.31	10
	ENERSM500	50	0.63	6.01	2.63	15
	ENERSM1000	100	0.63	12.27	3.38	32
RCS-Series Low Height Cylinders	ENERCS101	10	1.5	3.35	3.47	9
	ENERCS201	20	1.75	7.75	3.88	11
	ENERCS302	30	2.44	15.82	4.63	15
	ENERCS502	50	2.38	22.85	4.81	24
	ENERCS1002	100	2.25	44.18	5.56	50

* ENERSM-50 is fitted with an AR400 coupler



- Must wear eye protection
- Read safety precautions on pages W1 to W2

HYDRAULIC PUMPS



Air Hydraulic Pumps

Turbo II Air Pumps

- "Turbo" feature utilizes exhaust air to help power the pump
- Air exhaust muffler quieter operation and reduced operator fatigue
- Advance/Hold/Retract valve function



ENEPARG1102N



ENEXA12G

XA Series Air Pumps

- Finely metered flow for greated control
- Ergonomic design for less operator fatigue
- Pedal lock for retract or load holding
- ATEX Certified and included ground screw for explosion protection

Stock No.	Usable Oil Capacity (cu.in.)	Pressure Rating, PSI	Air Pressure Range, PSI	Air Consump, SCFM	Sound dBA	Weight (lbs)
ENEPATG1102N*	127	10,000	40-125	12	76	18
ENEPATG1105N	230	10,000	40-125	12	76	22
ENEPARG1102N	127	10,000	40-125	8-12	76	22
ENEXA12	122	10,000	40-125	10-35	72	22
ENEXA12G**	122	10,000	40-125	10-35	72	23

* Includes a 15-foot pendant for remote operation

**Includes an integrated pressure guage protected by the pump housing
Recommended Regulator-Filter Lubricator: ENERFL 102 for all air hydraulic pump models

Hand Pumps

Steel Hand Pumps

- Designed for maintenance, construction, lifting, and testing applications
- Two-Speed models reduce handle strokes by as much as 78% over ingle speed pumps
- Internal pressure relief valves for overload protection



Ultra High-Pressure Hand Pump

- Operational up to 40,000 psi., all other hand pumps have a 10,000 psi limit

Composite Hand Pumps

- Light weight and compact design, with lower handle effort
- Non-conductive fiberglass handle for operator safety
- Pump reservoir made of durable composite material for corrosion resistance

Stock No.	Description	Usable Oil Capacity (cu.in.)	Pressure Rating, PSI		Oil Displacement per Stroke, cu. in.		Maximum Handle Effort, (lbs)
			1st Stage	2nd stage	1st Stage	2nd stage	
ENEP39	Steel Hand Pump, Single Speed	40	N/A	10,000	N/A	0.16	85
ENEP80	Steel Hand Pump, Two-Speed	134	350	10,000	0.99	0.15	77
ENEP462	Steel Hand Pump, Two-Speed	453	200	10,000	7.69	0.29	110
ENEP2282	Ultra High-Pressure, Single Speed	60	200	40,000	0.99	0.037	106
ENEP391	Composite Hand Pump, Single Speed	55	N/A	10,000	N/A	0.151	85
ENEP142	Composite Hand Pump, Two-Speed	20	200	10,000	0.221	0.055	78
ENEP802	Composite Hand Pump, Two-Speed	155	400	10,000	2.4	0.151	95
ENEP392	Composite Hand Pump, Two-Speed	55	200	10,000	0.687	0.151	93

Electric Hydraulic Pumps

XC Cordless

- Portability of a hand pump with the speed of an electric pump
- Integrated handle and shoulder strap for maximum portability
- Bladder oil reservoir allows for pump operation in any position
- Pump models include two heavy duty, 28 V Lithium-ion, 3.0 amp-hour battery packs and quick charger



ENEXC1202MB



ENEXPUD1101B

PU Series

- Fully electric operation for maximum speed
- Pendant control of both motor and valve operation
- ENEPUD1101B offers advance/auto-retract operation through pendant
- ENEPUD1301B offers advance/hold/retract through pendant

Stock No.	Usable Oil Capacity (cu.in.)	Output Flow Rate (cu. in./ minute)		Voltage (VAC)	Weight (lbs)
		200 psi	10,000 psi		
ENEXC1201MB	61	125	15	115	20
ENEXC1202MB	120	125	15	115	22
ENEPUD1101B	231	200	20	115	35
ENEPUD1301B	231	200	20	115	35

Hydraulic Maintenance Sets

- All sets include Enerpac pump, hose, cylinder, and gauge
- Lock-on or threaded connectors
- Complete set for almost every maintenance application

The Universal Hydraulic Tool Box

Stock No.	Capacity, Using Attachments, (Tons)	Capacity, Without Attachments, (Tons)	Number of Components	Weight, (lbs)
ENEMS24	2.5	5.0	34	59
ENEMSFP5	2.5	5.0	24	44
ENEMS210	5.0	10.0	35	140
ENEMSFP10	5.0	10.0	22	105
ENEMS220	12.5	25.0	13	210
ENEMS21020	5.0 - 12.5	10.0 - 25.0	53	350



ENEMS210

Hydraulic Maintenance Set Components

Stock No.	Hand Pump	Hose	Cylinder	Gauge	Gauge Adaptor
ENEMS24	ENEP142	ENEHC7206	ENERC55	ENEGP10S	ENEGA4
ENEMSFP5	ENEP142	ENEHC7206	ENERC55	ENEG2535L	ENEGA3
ENEMS210	ENEP392	ENEHC7206	ENERC106	ENEGP10S	ENEGA2
ENEMSFP10	ENEP392	ENEHC7206	ENERC106	ENEG2535L	ENEGA3
ENEMS220	ENEP392	ENEHC7206	ENERC256	ENEGP10S	ENEGA2
ENEMS21020	ENEP392	ENEHC7206	ENERC102, ENERC106, ENERC256	ENEGP10S	ENEGA2

Vertical Lifting Wedge

- Enerpac vertical lifting wedge requires a .39 inch access gap
- Lifting force 16 ton at 10,000 psi hydraulic pressure
- Automatic mechanical retraction (single acting)
- Securely raises or lowers 16 tons with no slippage
- Lifting wedge ENELW16 includes safety block ENESB2
- Use in tandem to lift 32 tons, or 64 tons
- .83 inch of vertical lift from each step (maximum lift to 2.72 inches with optional ENELWB1 stepped block)



ENELW-16

Stock No.	Maximum Lifting Force (Tons)	Tip Clearance (in)	Max. Spread (in)*	Oil Capacity (Inches ³) Attachments, (Tons)	Maximum Operating Pressure (psi) Attachments, (Tons)	Lifting Stroke (in) Attachments, (Tons)	Weight, (lbs)
ENELW-16	16	.39	2.72	4.75 in ³	10,000	0.83	15.40

For using two or four lifting wedges simultaneously use split-flow manifolds ENEAM21 or ENEAM41

* Maximum spread 2.72 inches when using optional stepped block ENELWB1



- Must wear eye protection
- Read safety precautions on pages W1 to W2

HYDRAULIC PRESSES

Hydraulic H-Frame Press Sets

- Available in 10, 25, 50, 100, 150, and 200-ton capacities
- Press set includes H-frame press, cylinder, pump, load gauge, gauge adaptor, and 6-foot hose
- Designed for general maintenance, intermittent use
- Heavy-duty welded frame minimizes flex under load, lasting longer than bolted or pinned-style frames
- Exclusive "Hydra-Lift" system uses an 18" stroke, press-mounted hydraulic jack to adjust press bed height. (25-, 50-, 100-ton models only)
- Includes pump mounting bracket to support the pump
- Roller head design allows movement and locking of the cylinder from side-to-side for off-center pressing jobs (50- and 100-ton models only; 10- & 25-ton models are able to move side-to-side but do not have rollers)
- Adjustable work bed is supported by pin supports which are 10" apart
- V-blocks sold separately (come in pairs)



Optional V-Blocks

ENEIPE5060

Press Stock No.	Optional V-Blocks Stock No.	Power Source Type			Press Capacity, (Tons)	Maximum Bed Daylight, (in)	Maximum Bed Width, (in)	Cylinder Stroke Length, (in)	Cylinder Stroke Length (in)	Weight, (lbs)
		Hand	Electric	Air						
ENEIPA1220	ENEAI36			X	10	40.00	18.63	10	1-Speed	160
ENEIPE2505	ENEAI30		X		25	54.50	29.00	6	1-Speed	605
ENEIPA2520	ENEAI30			X	25	54.50	29.00	14	1-Speed	610
ENEIPE3060	ENEAI36		X		30	54.50	29.00	14	1-Speed	722
ENEIPE5060	ENEAI50		X		50	48.56	28.75	13	2-Speed	1,051
ENEIPE10060	ENEAI200		X		100	42.50	35.00	13	2-Speed	1,743

Roll Frame Presses

- Capacity of 50 to 200 tons
- Quality welded frame for maximum strength and long life
- Frame rolls easily on four steel roller bearings
- Hydraulic clamp cylinders lock frame into position
- Exclusive "Hydra-Lift™" bolster for effortless adjustment of the vertical daylight
- Standard roller head design allows movement of the cylinder from side to side
- All roll frame press models in the chart below have been matched to a pump, cylinder, hoses, and gauge, offering a complete package
- Roll Frame design features a stationary bed with the ability to support heavy loads



ENEIPR10075

Stock No.	Capacity (Tons)	Vertical Daylight (in)		Pump (Electric) Stock No.	Max. Bed Width (in)	Cylinder (Double-Acting) Stock No.	Stroke (in)	Speed (Seconds / Inch)		Weight, (lbs)
		Min	Max					Rapid Advance	Pressing	
ENEIPR5075	50	6	37.12	ENEZE4420SBN	28.75	ENERR5013	13.13	1.0	11.1	1,961
ENEIPR10075	100	6.28	41.28	ENEZE5420SGN	35.00	ENERR10013	13.13	1.5	10.3	3,849
ENEPR-20075	200	11	51	ENEZE5420SGN	48.00	ENERR20013	13.00	3.1	22.1	7,869



ENERFSM8
w/safety blocks



ENEFSH14
w/safety blocks

Hydraulic & Mechanical Industrial Spreaders

- For maintenance, commissioning, shutdowns, testing and valve change outs
- For disassembling and assembling flange joints safely & efficiently
- Safety blocks included with ENEFSH14 and ENEFSM8
- ENEFSB1 safety blocks sold separately in pairs

Stock No.	Maximum Spreading Force (Tons)	Tip Clearance in (mm)	Maximum Spread* in (mm)	Type	Weight (lbs)
ENEFSH14	14	.24 (6)	3.16 (81)	Hydraulic	15.7
ENERFSM8	8	.24 (6)	3.16 (81)	Mechanical	14.3

* Using stepped blocks ENEFSB1



ENEFS56

Hydraulic Flange Spreaders

- Adjustable jaw widths from 2.75" to 8.5" for a wide range of application
- Lightweight, ergonomic design for ease of use
- Single-acting, spring return Enerpac RC cylinders for fast trouble-free operation

Stock No.	Maximum Flange Thickness (in)	Stud Size (in)	Standard Wedge (in)	Capacity (tons)	Stroke (in)	Oil Capacity (in3)	Weight (lbs)
ENEFS56	2 x 2.25	.75 - 1.13	.13 - 1.13	5	1.5	1.5	2.0
ENEFS109	2 x 3.63	1.25 - 1.63	.13 - 1.13	10	2.13	4.8	9.1

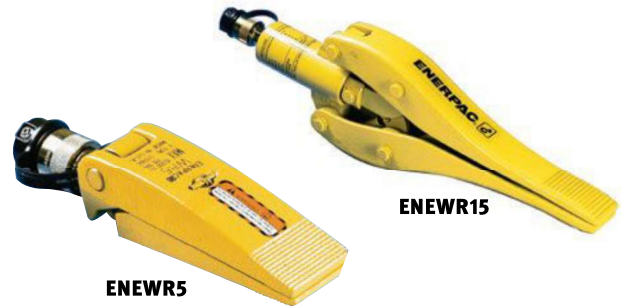

ENEWR5

ENEWR15

Hydraulic Spreader Cylinders

- ENEWR5 for use in very confined work areas
- ENEWR15 for long stroke spreading applications

Stock No.	Cylinder Capacity (Tons)	Tip Clearance (in)	Length (in)	Oil Capacity (in3)	Maximum Spread	Weight (lbs)
ENEWR5	1.00	.50	8.78	.61	3.70	5.0
ENEWR15	.75	1.26	21.65	3.91	11.50	25.0



ENEATM4

ENEATM9

Hydraulic & Mechanical Flange Alignment Tools

- ATM-Series tools rectify twists and rotational misalignment quickly, safely, and without the need for an external power source
- Appropriate for use on most ANSI, API, BS and DIN flanges
- No slings, hooks or lifting gear required
- Can be installed and used in any position (horizontally or vertically)
- Portable, light weight design enables easy transport and use, even in remote locations

Stock No.	Maximum Force (ton)		Minimum Bolt Size		Flange Wall Thickness (max)		Weight	
	(ton)	(kN)	(in)	(mm)	(in)	(mm)	(lbs)	(kg)
ENEATM2	1	10	0.63	16	.55 - 3.29	14 - 82	3.5	1.6
ENEATM4	4	40	0.95	24	1.18 - 5.23	30 - 133	19	8.6
ENEATM9*	10	90	1.24	31.5	3.66 - 9.00	93 - 228	32	14.5

* At 10,000 PSI maximum operating pressure

** ENEATM9 includes hand pump and hydraulic hose (gauge sold separately, weight includes tool only)



- Must wear eye protection
- Read safety precautions on pages W1 to W2

HYDRAULIC SPECIALTY TOOLS



Hydraulic Nut Splitters

- Heavy-duty chisels can be reground
- Applications include servicing trucks, piping industry, tank cleaning, railroad, petrochemical, steel construction, mining, etc.
- Does not damage stud of bolt. (Not for use on square nuts)
- Nut splitters include a spare chisel, a spare set screw, and the wrench used to secure the chisel
- Maximum allowable hardness of nuts to split is HRC44



ENENC2432

Stock No.	Bolt Range (in)	Hexagon Nut Range (in)	Capacity (ton)	Oil Capacity (in ³)	Weight (lbs)	Replacement Blades Stock No.
ENENC1319	.31-.50	.50-.75	5	.92	1.8	ENENCB1319
ENENC1924	.50-.63	.75-.94	10	1.22	4.4	ENENCB1924
ENENC2432	.63-.88	.94-1.13	15	3.66	6.6	ENENCB2432
ENENC3241	.88-1.13	1.13-1.56	20	4.88	9.7	ENENCB3241
ENENC4150	1.13-1.38	1.56-2.00	35	9.46	18	ENENCB4150
ENENC5060	1.38-1.50	2.00-2.25	50	14.64	26	ENENCB5060
ENENC6075	1.50-1.88	2.38-2.88	90	30.00	75.1	ENENCB6075



Easily removing rusty nuts during railroad construction is just one of many application examples for the Enerpac Nut Splitter.

Hydraulic Cutterheads

- Single acting, spring return on all models, except WHR-1250
- Guillotine action for efficient operation
- Lifting handles on larger models
- Carrying bag included for easy carrying and tool protection
- Ideal for use with most Enerpac pumps featuring 3-way valve or dump valve and 10,000 psi pressure rating (except WHR-1250, which requires 4-way valve)
- CR-400 coupler and dust cap included on all models
- Selection chart provides cutting capacity for each tool

Type	Stock No.	Capacity (ton)	Oil Capacity (in ³)	Length (in)	Steel Wire Rope, Hempcore or IWRC 6x7, 6x12 or 6x19	Round Bar				Wire Strand				Cable		Wt. (lbs)	Replacement Blades Stock No.
						Copper Wire or Bar	Alum. Wire or Bar	Soft Steel Bolts	Rein-forcing Bar	Bare Copper Wire Strands	Bare Alum. Wire Strands 6x7	ACSR Wire Strands	Guy Steel Wire Strands 1x7 1x19	Tele- phone Cable CPP	Under ground Cable (Power)		
Single-Acting Hydraulic Cutterheads with Spring Return	ENEWHC750	4	1.20	5.00	0.63	0.75	0.75	0.75	.50***	0.75	.75	0.75	0.63	##	##	7	ENEWC750
	ENEWHC1250	20	8.20	11.00	1.25	1.13	1.25	1.13	1.00	1.25	1.25	1.25	0.88	##	##	25	ENEWC1250
	ENEWHC2000	13	7.30	15.00	1.00	1.25	1.25	0.88	##	2.00	2.00	2.00	0.75	##	2.00	23	ENEWC2000
	ENEWHC3380	3	4.00	19.00	##	##	##	##	##	1.63	1.69	##	##	3.38	3.38	20	ENEWC3380
	ENEWHC4000	8	8.40	24.00	##	##	##	##	##	##	##	##	##	4.00	4.00	32	ENEWC4000
Double-Acting Hydraulic Cutterhead	ENEWHR1250	20	7.50	16.50	1.25	1.25	1.25	1.13	1.00	1.25	1.25	1.25	0.88	##	##	26	ENEWC1250

Will not cut designated material *** Low alloy material



Hydraulic Cutterhead Sets

- Everything needed to start the job immediately
- Sets include cutterhead, pump, and hose
- Foot pump frees hands for versatility

Stock No.	Pump Type	Cutter Stock No.	Pump Stock No.
ENESTC750H	Hand Pump	ENEWHC750	ENEP392
ENESTC750A	Air Operated Pump	ENEWHC750	ENEPATG1102N
ENESTC1250H	Hand Pump	ENEWHC1250	ENEP392
ENESTC1250A	Air Operated Pump	ENEWHC1250	ENEPATG1102N
ENESTC750FP	Foot Pump	ENEWHC750	ENEP392FP
ENESTC1250FP	Foot Pump	ENEWHC1250	ENEP392FP

Self-Contained Hydraulic Cutters

- Self-contained cutters contain built-in hydraulic pumps to achieve maximum convenience and portability
- Rotating heads for operator convenience
- Guillotine action (except WMC-1000) for efficient operation
- Carrying bag included for easy carrying and tool protection
- Velcro straps to secure handles on larger models for easy transportation
- Spring return on all models
- Lightweight, self-contained tool, can be used anywhere
- Selection chart provides cutting capacity for each tool



Stock No.	Capacity (ton)	Length (in)	Steel Wire Rope, Hempcore or IWRC 6x7, 6x12 or 6x19	Round Bar				Wire Strand					Cable		Weight (lbs)	Replacement Blades Stock No.
				Copper Wire or Bar	Alum. Wire or Bar	Soft Steel Bolts	Reinforcing Bar	Bare Copper Wire Strands	Bare Alum. Wire Strands 6x7	ACSR Wire Strands	Guy Steel Wire Strands 1x7	Guy Steel Wire Strands 1x19	Telephone Cable CPP	Underground Cable (Power)		
ENEWMC580	4	15.00	.63	.63	.63	.63	.38	.63	.63	.63	.56	.56	##	.63	8	ENEWCB750
ENEWMC750	4	15.00	.63	.69	.69	.69	.50***	.75	.75	.75	.56	.56	##	.68	8	ENEWCB750
ENEWMC1000*	20	26.75	##	.75	.75	.75	.75	##	##	##	##	##	##	##	25	ENEWCB1000
ENEWMC1250	20	26.75	1.25	1.13	1.25	1.25	.88	1.25	1.25	1.25	.88	1.00	##	##	23	ENEWCB1250
ENEWMC1580	6	22.00	.75	.75	.75	.75	##	1.50	1.63	1.63	.63	.63	33	1.63	15	ENEWCB1580
ENEWMC2000	13	24.75	1.00	1.25	1.25	.88	##	2.00	2.00	2.00	.75	.75	##	2.00	24	ENEWCB2000
ENEWMC3380	3	26.00	##	##	##	##	##	1.83	1.69	##	##	##	3.37	3.38	22	ENEWCB3380

* ENWMC1000 cuts .50" alloy chain grade 70 (type G7 transport or tie-down or grade 80 (for overhead lifting applications) ## Will not cut designated material *** Low alloy material

Enerpac System Components

HF OIL

- Specially formulated for power pumps
 - maximum volumetric efficiency
 - maximum heat transfer
 - prevents cavitation
 - anti-sludge, anti-rust, anti-foam additives
- Maximum film protective lubricity
 - anti-oxidation additives

LX Hand Pump Oil

- Specially formulated for power pumps
 - anti-sludge, anti-rust additives
- Reduced handle effort over HF oil
 - good low temperature performance
- Not for use in power pumps



HF-100



LX-101

Stock No.	Contents	Stud Size (in)
HF-100	1 Quart	High viscosity index ensures maximum lubricity over a wide range of operation temperatures
HF-101	1 Gallon*	
HF-102	5 Gallons	
HF-104	55 Gallons	
LX-101	1 Gallon**	

* Packed in two 2 1/2 gallon cans

** Hand pump oil.

	LX Oil	HF Oil
ISO Grade	15	32
Viscosity Index	105 min	100 min
Viscosity at 210°F	38 S.U.S	44 S.U.S
Viscosity at 100°F	82 S.U.S	164 S.U.S
Viscosity at 0°F	<1635 S.U.S	<7236 S.U.S
API Gravity	34.2	31.0/33.0
Flash, C.O.C. °F	375	400
Pour Point, °F	-45	-45
Paraffinic Base Color	Yellow	Blue

NOTE: SAE grades do not apply to hydraulic oil.



- Must wear eye protection
- Read safety precautions on pages W1 to W2